Electric Water Purifier

WATER
PURIFIER

User Manual

CP-AAN100ULW

CUCKOO



CUCKOO

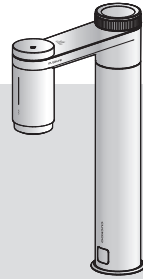

Dear customers!

Thank you very much for using the CUCKOO Electric Water Purifier

Please retain this manual (including the Warranty) for future reference.

This manual will be of great help should you have any questions or if the functions do not work properly.

Features and Benefits of CUCKOO Electric Water Purifier

Product Benefits

- **Nano Positive Filtering System**
Application of CUCKOO Electric Water Purifier's Nano Positive Filtering System produces clean and healthy water containing minerals.
- **Healthy electric water purifier**
You may drink water, which has passed a filter in an instantaneous cooling, heating or purification method, as cold, hot or room temperature water.
- **Water purifier featuring an ultraslim design and Multiple functions**
Cold water, hot water, room temperature water and Cleansing Water are available in a single water purifier and, thanks to its slim and classy design, spaces can be used in a more efficient manner.
- **Electrolytic Cleansing System**
An Electrolytic Cleansing System is applied to enable sanitary use of the water purifier, and Cleansing Water is dispensed as the sink faucet to utilize it to clean food ingredients and kitchenware.
- **Economical and Eco-Friendly Water Filtration System**
An extremely economical and eco-friendly water purification system, which produces no wasted water in the process of water filtration through a Nano Positive Filter, has been selected.
- **Button Lock/Functional Lock**
To prevent potential accidents as a result of product misuse by children or the elderly, Button Lock and Functional Lock (hot water, Cleansing Water) have been added.
- **Water Leak Prevention System**
Water leakage that may be caused during product usage is detected and prevented to enable safe use of the water purifier.
- **Non-stop Dispensing Function**
You can continuously dispense cold water, hot water, and room temperature water.
- **Fixed Quantity Dispensing Function**
It is convenient to be able to dispense a fixed quantity, either One Cup (about 250cc) or Half Cup (about 120cc), of cold water, hot water or room temperature water.

This manual includes the warranty.

Before using the product, make sure to read the "User Manual" to use it accurately. After reading it, please keep it in a place where people who use the product can access it anytime.

Caution: This product is for household use, and other uses (industrial, experimental, etc.) are prohibited. In order to use this product for a long time without malfunctioning, please read this User Manual.

CONTENTS

Before Use	● Features and Benefits of CUCKOO Electric Water Purifier	2
	Warnings for Safe Use	4~7
	Cautions for Safe Use	8~9
	Part Names and Accessories	10~11
During Use	● Filtration Circuit / Filtration System	12
	How to Install the Product	13
	Use the Checklist Before Use	14
	How To Use	15~28
	How To Clean	29
	How To Replace the Filters	30~31
	Expected Filter Replacement Cycle / Recommendations / Filter Arrangement	32
Before Asking for Support	● Please check before asking for support.	33~34
Service Guide	● Product Specifications	35



Warnings for Safe Use

- Please comply with the "Safety Warnings" to ensure safe and proper use of the product and to avoid accidents or dangerous situations.
- The 'Warnings for Safe Use' section consists of "Warning" and "Caution" items, which are defined as follows.

Warning

Potentially dangerous situations that can cause serious injuries or death if not avoided.

Caution

Potentially dangerous situation that can cause minor injuries if not avoided.



- This symbol indicates a potentially dangerous situation under specific circumstances.
- Please read the details carefully and follow the instructions to avoid dangerous situations.



- This symbol is used to indicate actions that are 'prohibited'.



- This symbol is used to indicate 'instructed' actions.

About Power

Warning

Prohibited

Make sure to use it on an outlet exclusively for 220V -240V and the current rating of 13A or greater that can be grounded, and do not insert power plugs of several products in a single outlet at the same time.

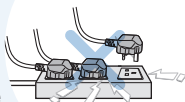

- If you use it with a lot of products, this may cause a fire or an electric shock. Please check the power outlet regularly.
- If it is not properly grounded, this may cause electric shock due to a short circuit.
- If there is a foreign substance or moisture on the Power Plug, wipe it thoroughly before use.

If a Power Cord or a Power Plug is damaged or when the Power Outlet is shaky, stop using the product and contact our Customer Service Center.



- If the sheath of the power cord is peeled off or severed during use of the product due to negligence, it may cause fire or electric shock. Thus, please frequently check the condition of the power cord, power plug and power outlet.
- To prevent dangerous situations arising from the damage of the power cord or the power plug, please contact the manufacturer, distributor or certified technician (service staff) for replacement of the cord.
- We strongly recommend that the damaged parts be repaired at a designated service center.
- This may cause electric shock, short circuit, and fire.

Do not bend, tie or pull the Power Cord by force. protection. Do not plug in multiple devices into the same power outlet or extension cord simultaneously.

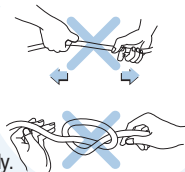

- This may cause electric shock or fire due to a short circuit.

If there is any moisture, dust, or foreign substances on the Power Plug, remove them with a dry cloth.



- This may cause electric shock or fire. Please check the Power Plug frequently.

Do not use an attachable multi-power outlet.



- This may cause a fire or electric shock.

If you use a movable extension cord, use only a single product for an extension cord of 13A of current capacity and ensure that it is properly grounded.



- This may cause a fire or electric shock.



About Power



Warning



Prohibited

When unplugging the product, make sure to hold the Power Plug, not the Power Cord.

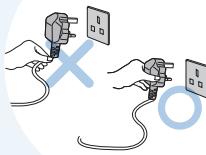

- Applying force to the Power Cord may cause electric shock or fire. Please check the Power Plug and the Power Cord frequently.

Use alternating current voltage of 220V-240V only.

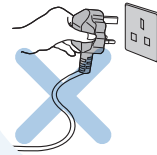

- This may cause electric shock and/or fire.
- The product will not work properly.
- Please check the Power Plug and the Power Cord frequently.

During water leakage or cleaning, make sure to close the Tap Water Supply Valve and pull out the plug.

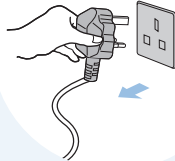

- There is a risk of electric shock or malfunction. Please check the Power Plug and the Power Cord frequently.

When inserting or pulling out the Power Plug to and from the Power Outlet, first remove any moisture on your hands and then put in or pull out the Power Plug when holding it.

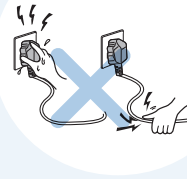

- Pulling out the Power Plug with wet hands can cause electric shock.
- Pulling the power cord by excessive force can damage the Power Cord, causing a short circuit or electric shock. Please check the Power Plug and the Power Cord frequently.

Make sure the Power Cord is not under a heavy object or near sharp objects. Take special caution to ensure that it is not easily damaged by your pet.



- If you do not do so, this may cause damage to the cord, leading to there is an extra space here electric shock or fire. Please check the Power Cord frequently.

When you do not intend to use the product for a long time, Close the valve, empty out the refrigerant tank and pull out the power plug.

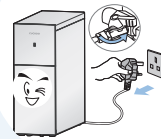

- Before reuse, fill it with water and then empty it out or run the Immediate Cleansing function.
- Before reuse, refer to the "Checklist Before Use" (Page 14)

Please also unplug the product before inspection, repair or replacement of its parts.

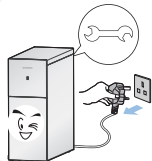

- If you do not do so, this may cause damage to the cord, leading to there is an extra space here electric shock or fire. Please check the Power Cord frequently.

If water enters the power supply area, unplug the product and dry it completely before use.



- This may cause electric shock or fire. Please check the Power Plug and the Power Cord frequently.



Warnings for Safe Use

About Installation

⚠ Warning ⚡ Prohibited

Do not install this product in places with a lot of dust, places with significant temperature changes (outdoors, greenhouses, etc.), or places with direct contact with water.



- Install this product in a clean environment.
- Failure to do so may cause product failure, electric shock, or fire.

Do not install the product near the bathroom.

Do not install the product on an uneven surface or a slope, or on a pad, cushion, blanket or carpet.

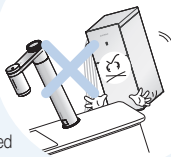

- This may cause malfunction, unwanted noise or injury. Please check the product regularly if it is working properly.
- This may cause product damage and fire.

Avoid direct sunlight and high temperatures.

- This may cause color changes or discoloration.
- Please check the Power Cord frequently.

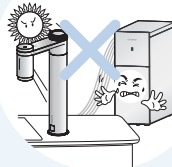

Make sure that the length of the Tap Water Supply Tube doesn't exceed 5 m from the Tap Water Supply Valve.

- If you do not do so, it may cause poor performance of the product.



Secure at least 20cm from walls and install the product on a solid and flat surface.

- If you do not do so, it may cause poor performance of the product.

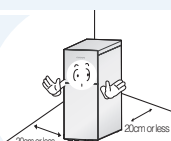

Do not install the product in a place from which gas may be leaked or where an air conditioner or a heater is located.

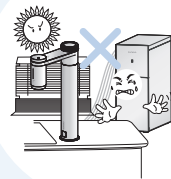

- There is a risk of explosion or fire.

Always use the water supply for tap water, and install the Tap Water Supply Valve near the Cooling Water Pipe.



- Do not use water sources other than tap water, such as groundwater.
- Filter change cycles can vary according to the region and capacity of water use.
- Installing it in a hot water pipe may cause damage to the filter and/or product.

Avoid installing a product outdoors or in a place where the surrounding temperature drops below 5°C.

- This may cause the filter, tubing or any other components to freeze, causing malfunction of the product.
- The temperature of the environment for using the product is 5-40°C.



Do not lift the drain hose, which is connected to the product, over the surface where the product is installed, and do not connect it to the water purifier over a distance of 3m or greater.

- The drainage function may not work smoothly.

When connecting the drain hose to the drain while letting the hose touch the floor of the kitchen, etc., do not lift it 30cm or higher from the floor.

- The drainage function may not work smoothly.

Warnings for Safe Use



During Use



Warning



Prohibited

Do not use the product by placing an electric heating appliance such as a microwave, electric oven and toaster on top of it, or place an inflammable substance such as a candle, gas container and/or lighter on the product.

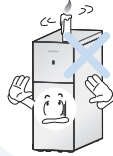

- There is a risk of fire, electric shock or accidents.

Do not place chemicals, water bottles or small metal materials on top of the product.



- If any of it gets into the product, there is a risk of fire and/or damage to the product.

When moving the product, do not pull the power cord and connection hose or grab the outlet area.



- This may cause damage to the product.

Do not disassemble or remodel the product.

- This may cause fire and/or electric shock.
- Do not allow anyone other than authorized service providers to disassemble or repair the product.



This device is not made to be used by persons (including children) who are unable to use it safely without supervision or guidance for lacking the bodily, sensory and/or mental capacity or the experience and knowledge.



- This may cause damage to the product.

※ Cleansing water is not for drinking. Prevent anyone from drinking the Cleansing water.

※ Use Cleansing water to Clean fruits, vegetables and utensils, which are to be cleaned with a sink faucet.



Warning



Instructed

If water leaks from the inside of a product or forms a puddle in the surroundings, close the Tap Water Supply Valve, turn off the Power button, pull out the power plug and contact our Customer Service Center.



- There is a risk of electric shock.

If you smell burning or see smoke arising from the product, unplug it immediately and close the Tap Water Supply Valve. After that, please contact our Customer Service Center.

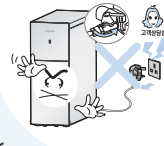

- This may cause damage to the product.

Be careful when using high-temperature water or hot water.

- Hot water (high-temperature water) may be splashed so make sure it does not come into contact with the body. (Be careful, especially, when the elderly or children use the product.)
- After stopping or terminating the dispensing of hot water (high-temperature water), some water may drip from the inside of the outlet so take out the cup after confirming it.



The product should be installed and removed by our service technicians through the Customer Service Center.

Pay attention to children or anyone not to control the Control Panel too often.

- This may cause damage to the product and/or a safety-related accident.

When replacing the filter, close the Tap Water Supply Valve (adapter). (The Tap Water Supply Valve is typically located below the sink or at the faucet.)

- This may cause a water leak.

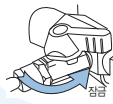

Prevent an air intake hole, air discharge hole, and gaps from being blocked or having foreign substances stuck inside such as a needle, cleaning pin, and metals.

- If you do not do so, this may cause an electric shock or fire.



Cautions for Safe Use



Warning



Instructed

Make sure the Cooling Water Tank Cover inside the product and the Top Cover are completely closed before use.

- It's also to keep foreign material away.



If the product has not been used for a long period of time, perform the Immediate Auto Cleansing function once before use.

- Use the Immediate Cleansing function to be able to easily clean the pipes and refrigerant tank (refer to Page 20).

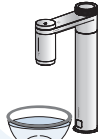

Do not use water from the purifier for a fishbowl or fish tank.

- The room temperature water may not be suitable for breeding fish. Depending on the circumstances, fish may die.

Must not use NON-Cuckoo Water Purifier filters.

- Use of a non-genuine filter other than a genuine CUCKOO filter may deteriorate the water purification performance, strange taste of the water, leakage and/or damage to the product.

Replace the filters according to the replacement cycle.

- If you do not do so, This may cause poor filter performance or bad odor.
- Regarding the filter replacement cycle, refer to Page 32.



When gas or propane leaks, do not pull out the Power Cord of the product but immediately open the windows to ventilate.

- This may cause a fire or electric shock.



Do not lean the product at a 30-degree angle or more when moving the product.

- This may cause poor performance of the product.

If there is moisture on the LCD touch panel and top of the faucet, please remove the moisture before use.

- Failure to do so may cause decreased performance and product failure.

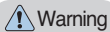

Warning



Prohibited

Do not clean the product using benzene or thinner.

- There is a risk of damage to the product.



Do not move the product while it is in operation.

- Do not move or shake the product when it's turned on. It may cause the connecting tube to be separated, leading to a malfunction of the product and water leak.

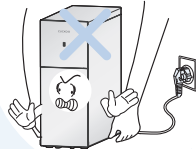

During use of the product, do not pull the hose on the back of the product.

- This may cause damage to the product due to water leakage.

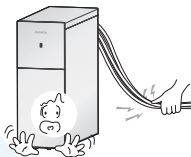

Do not place magnetic objects on this product.

- Doing so may cause product malfunction.

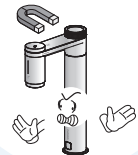

Cautions for Safe Use



Warning

Instructed

Do not allow children to touch packing material such as styrofoam and vinyl.



- This may cause suffocation.

Prevent children from climbing or hanging on the product.



- This may cause the product to fall down, leading to injury of the children.

Do not connect anything other than the water supply to the Tap Water Supply Pipe.



- Water other than the tap water (drinking water) may cause disease.
- It may cause a malfunction or reduce the lifecycle of the product.

Do not install the product in a place such as below.

- Outdoors
- A place exposed to direct sunlight
- Near a bathroom
- In front of a cooler or a heater
- On a slope

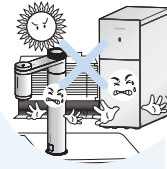

Do not repeatedly operate the hot water dispensing and stoppage operations.

- This may cause a malfunction of the product.
In particular, steam may occur.



Do not damage the refrigerant circuit.



- This may cause a malfunction of the product.

Please take caution when using steam Cleaning.

- During steam Cleaning, make sure that steam does not reach the body. (Extra caution is required for the elderly and children.)
- During steam Cleaning, do not grab or remove the Cleaning cup. (Regarding how to cancel Cleaning, refer to page 20)



Do not randomly connect an apparatus to reduce pressure to the Hot Water Apparatus Pipe.

- In particular, it may cause steam.

During Use

This product is exclusively for AC 220V-240V only, and make sure to use an outlet exclusively for 220V-240V that can be grounded.

When you use an extension cord (such as a multi-power outlet), do not simultaneously connect any other product. Failure to ground may cause electric shock due to a short circuit.

Be sure to only use the product after grounding.

1 In the case of an outlet with a grounding terminal

When there is a grounding terminal, you can immediately use the power outlet without any extra work.

2 In the case of an outlet without a grounding terminal

Check if the earth leakage breaker is installed and, if it is not installed, install one and then use the product. If there is no earth leakage breaker, it may cause a fire.



Part Names

Part Names

Main body (Front, back)

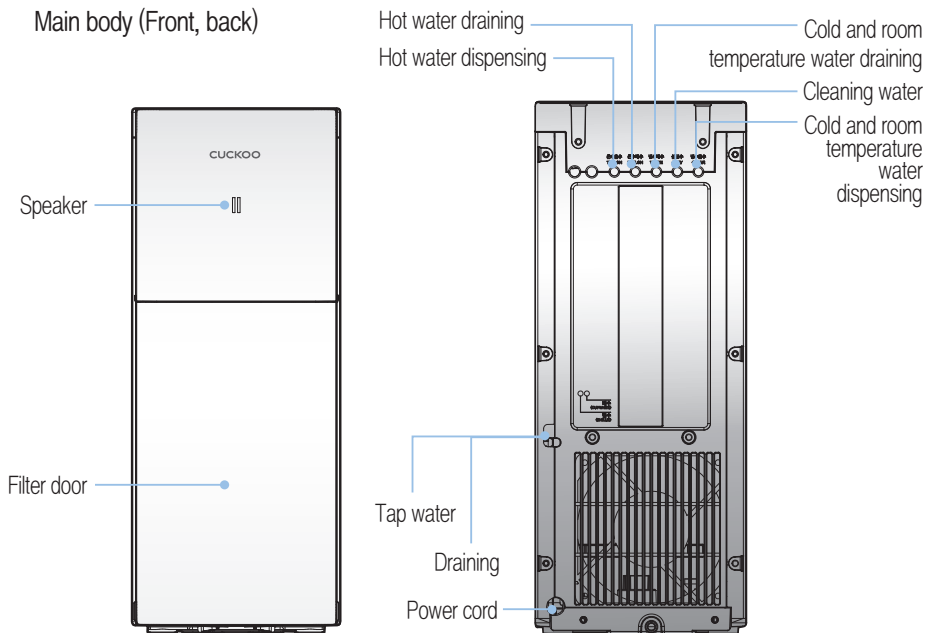

Faucet (Side, top) ※ LCD GUIDE is not a control panel. Applying force may cause damage.

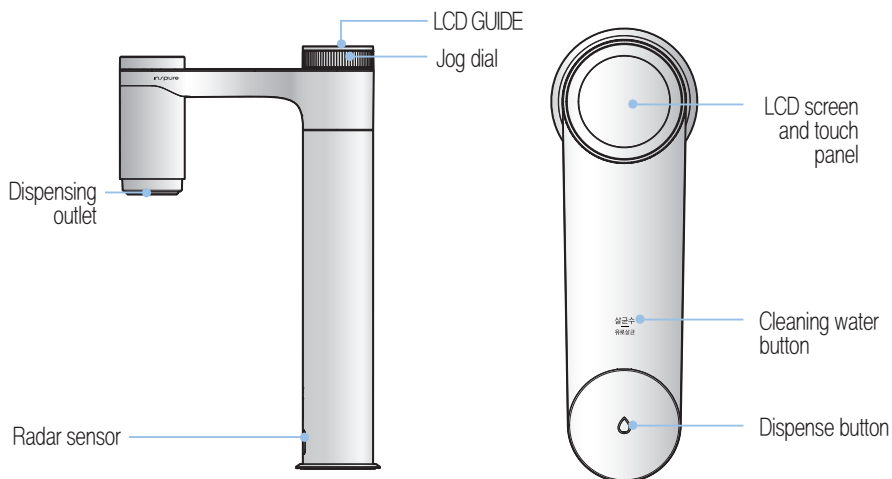



Part Names

Part Names

〈Detailed Description of the Display Panel〉

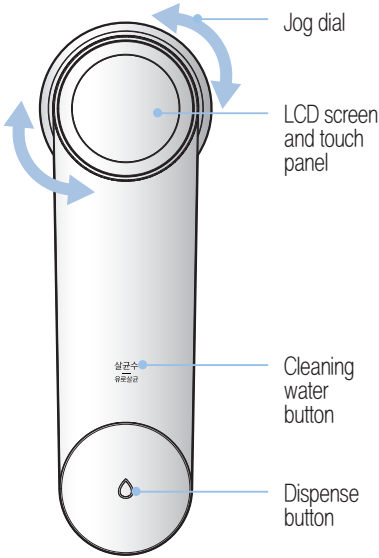

LCD touch operation names

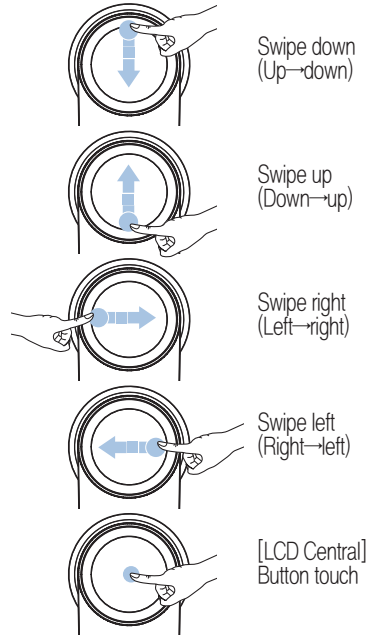

Accessories

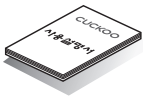

User Manual



Service Card

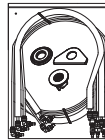

Tubing and installation materials



Cleansing Cup
(If it is lost, contact to Customer Service Center to purchase a new one)



Water Purification System

Water Purification System

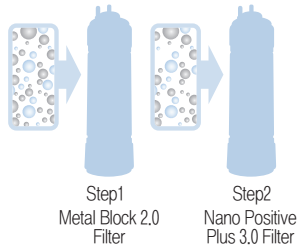

LEVEL	Filter Name	Filter Function
Level 1	Metal Block 2.0 Filter	Absorbs and removes seven heavy metals (mercury, lead, cadmium, arsenic, iron, aluminum, copper), organic chemicals, etc.
Level 2	Nano Positive Plus 3.0 Filter	Absorbs and removes particulates, Escherichia coli, Pseudomonas aeruginosa, Staphylococcus aureus, and norovirus.

※ Using a non-Cuckoo filter or using a genuine Cuckoo filter for an extended period may result in poor filter performance.



How to Install the Product

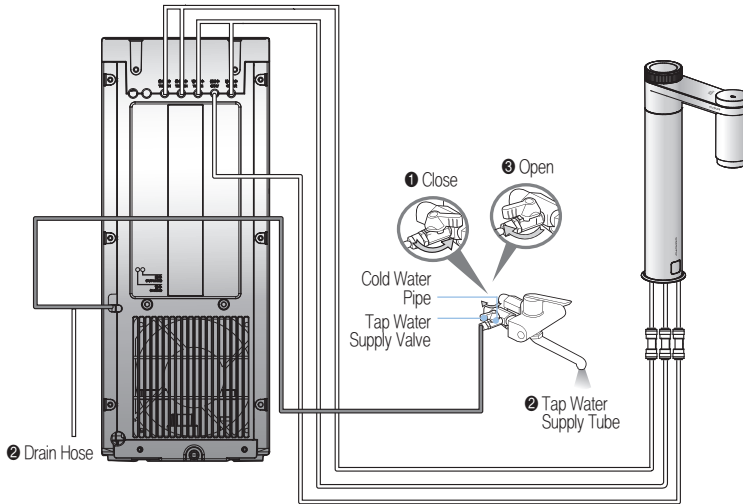

- 1 Install the Tap Water Supply Valve and turn it to CLOSE.
 - Please make sure that you use tap water from the water supply. Do not use other water sources, such as groundwater.
- 2 Connect the Tap Water Supply Hose to the inlet and the Drain Hose to the drain.
 - (When installing the sink faucet) Connect the sink faucet connection hose, sink faucet dispensing hose and cleansing water hose to the sink faucet connection area.
 - Fix the Drain Hose so that water discharged from the hose does not splash to the surroundings.
 - Do not place the Drain Hose above the installation surface or connect it to the water purifier over a distance of 3m or greater.
 - When connecting the drain hose to the drain while letting the hose touch the floor of the kitchen, etc., do not lift it 30cm or higher from the floor.
- 3 Turn the Tap Water Supply Valve to OPEN.
- 4 Connect the power.
- 5 Use the Auto Filter Cleaning function to clean the filter (regarding the Auto Filter Cleaning, refer to Page 24).

After the installation has completed, please check if water leaks from the tube connecting parts.

- Tap Water Supply Valve (Tube) • Tap Water (Inlet) Hose, Drain Hose • Faucet Connection Hose

- ※ Installing the product around a sink is recommended.
- ※ In order to guarantee the optimum performance of the product, consult with the technician of our company about the detailed method of installation.
- ※ The water used for inspection process during production of the product may remain inside the product. Do not worry as it is not a used product.
- ※ When installing the product, do not reuse the Tap Water Supply Valve and the tubes that were Used before.
- ※ During initial installation (filter replacement), operate the Auto Filter Cleaning function for 10 to 15 minutes.



Checklist Before Use

Checklist Before Use

- 1 Open the Tap Water Supply Valve.
 - ▶ Open the Tap Water Supply Valve, and check if there is water leak on each connection part.
 - Tap Water Supply Valves and water (inlet) and drain of the product

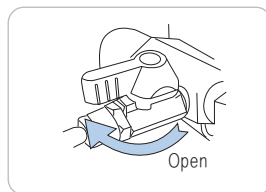

- 2 Turn the Close lever of the filter door on the right side of the product to the CLOSE direction.
 - Water is supplied to the water purifier.

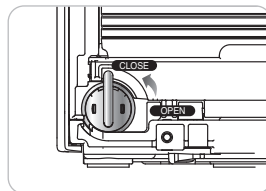

- 3 Connect the power.
 - ▶ This product is exclusively for 220V-240V .
 - Please make sure to plug it into a proper outlet.

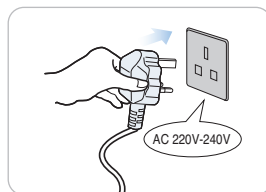

- 4 Exchange and manage the filter on a regular basis.
 - ▶ Please clean and replace the filters regularly so that you can always enjoy pure and clean water.
 - ▶ Regarding the filter replacement cycle, refer to Page 32.

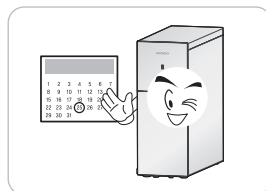



To Set Functions

1 Standby Mode

- ▶ The dispensing standby mode for dispensing cold water, hot water, room temperature water, and cleaning water. The LCD panel turns on according to the selected function and displays the dispensing volume.
- ▶ If the product is idle for 15 seconds, the LCD panel will automatically turn off.
- ▶ If the product detects the presence of a human while the LCD panel is off, the screen will automatically turn on. (For use of Hidden Display, please refer to page 21.)

2 User Settings mode

- ▶ In Standby mode, swipe down (up→down) to enter User Settings mode, and adjust the functions.

User Settings mode	
To enter User Settings mode	Favorite the Flow Settings
Swipe left (right→left) once	Flow Mode Settings
Swipe left (right→left) 2 times	Voice Volume Settings
Swipe left (right→left) 3 times	Mood Lamp Settings
Swipe left (right→left) 4 times	Auto Filter Cleaning
Swipe left (right→left) 5 times	Screen Rotation Settings
Swipe left (right→left) 6 times	Power Save Time Settings
Swipe left (right→left) 7 times	Flow Origin Adjustment Settings
Swipe left (right→left) 8 times	Draining
Swipe left (right→left) 9 times	Cleaning Cycle Settings
Swipe left (right→left) 10 times	Cleaning Module Replacement Notification settings
Swipe left (right→left) 11 times	Filter Replacement Notification Settings
Swipe left (right→left) 12 times	LCD Central Button Settings

3 Dispensing of fixed volume

- ▶ Press the [Dispense] or [LCD Central] button once to dispense a fixed volume of water.
- ▶ Use the [Jog Dial] to select the desired volume.
(Half cup → One cup → Two cups → Non-stop → Favorite volume → Repeat)
- ▶ You can select various fixed volumes through Flow Mode Settings.
- ▶ Refer to page 22 for details on how to use Flow Mode.



How to Use

To Set the Cold Water Function

- 1 If the Cold Water function is turned off, enter Cold Water Settings mode and disable the Cold Water Lock function.

- ▶ Swipe up (down→up) on the Cold Water function screen to enter Cold Water Lock Settings mode.
- ▶ After entering Cold Water Lock Settings mode, swipe left or right to select Disable Cold Water Lock and press the [LCD Central] button to confirm.



- 2 If you do not want to use cold water, enter Cold Water Lock Settings mode and enable the Cold Water Lock function.

- ▶ Swipe up (down→up) on the Cold Water function screen to enter Cold Water Lock Settings mode.
- ▶ After entering Cold Water Lock Settings mode, swipe left or right to select Enable Cold Water Lock and press the [LCD Central] button to confirm.



좌우
드래그

- ※ Stable dispensing of cold water is available approximately 1 hour after turning on the Cold Water function.
- ※ Product functions are set to On by default.

To Use Cold Water

- 1 Swipe left or right on the Standby screen to select the Cold Water function screen.

- ▶ The voice guide will say, "Cold water."

- 2 Dispensing a fixed volume

- ▶ Turn the [Jog Dial] to select the desired dispensing volume.
- ▶ Press the [Dispense] or [LCD Central] button once. Cold water will be dispensed.
- ▶ Dispensing will stop when the selected fixed volume is dispensed.
- ▶ Pressing the [Dispense] button or any other button during dispensing will stop the dispensing process.

- 3 When dispensing cold water, the dispensing outlet is illuminated.

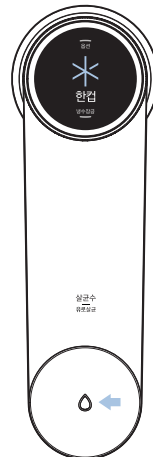



To Use Room Temperature Water

- 1 Swipe left or right on the Standby screen to select the Room Temperature Water function screen.
 - ▶ The voice guide will say, "Room temperature water."
- 2 Dispensing a fixed volume
 - ▶ Turn the [Jog Dial] to select the desired dispensing volume.
 - ▶ Press the [Dispense] or [LCD Central] button once. Room temperature water will be dispensed.
 - ▶ Dispensing will stop when the selected fixed volume is dispensed.
 - ▶ Pressing the [Dispense] button or any other button during dispensing will stop the dispensing process.
- 3 When dispensing room temperature water, the dispensing outlet is illuminated.

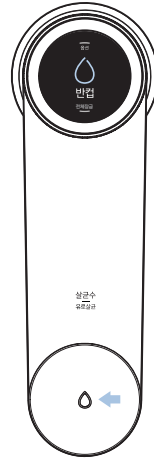

To Set the Hot Water Lock Function

This is a safety feature that prevents accidental use by children and others, protecting them from burns.
If this function is enabled, the [Hot Water] dispensing function will not operate.

- 1 If you do not want to use hot water, enter Hot Water Lock Settings mode and select the Hot Water Lock function.
 - ▶ Swipe up (down→up) on the Hot Water function screen to enter Hot Water Lock Settings mode.
 - ▶ After entering Hot Water Lock Settings mode, swipe left or right to select Enable Hot Water Lock and press the [LCD Central] button to confirm.



좌우
드래그





How to Use

To Use Hot Water (Standard 100°C)

- 1 Swipe left or right on the Standby screen to select the Hot Water function screen.
 - ▶ The voice guide will say, "Hot water."
- 2 Dispensing a fixed volume
 - ▶ Turn the [Jog Dial] to select the desired dispensing volume.
 - ▶ Press the [Dispense] or [LCD Central] button once. Hot water will be dispensed.
 - ▶ Dispensing will stop when the selected fixed volume is dispensed.
 - ▶ Pressing the [Dispense] button or any other button during dispensing will stop the dispensing process.
- 3 When dispensing hot water, the dispensing outlet is illuminated.
- 4 The temperature may differ depending on the surroundings and service conditions.

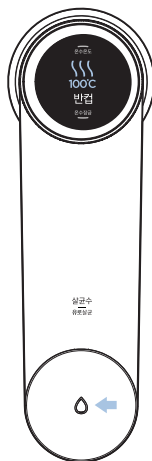

※ Place the cup close to the dispenser to prevent splashing of hot water and risk of burns.

※ Heed caution as the dispensed water may shake while dispensing hot water, depending on the tap water pressure.

※ Caution

Heed caution as the dispensing outlet may become hot with prolonged, repeated use of hot water (high-temperature hot water).

To Use the Hot Water Temperature Function (Customized Hot Water)

- 1 How to Use the Hot Water Temperature Function
 - ▶ Swipe down (up→down) on the Hot Water function screen to enter Hot Water Temperature Settings mode.
 - ▶ Swipe left or right on the Hot Water Temperature Settings screen, select the desired temperature, and press the [LCD Central] button.
100°C→40°C→50°C→60°C→70°C→80°C→Repeat
 - ▶ After selecting the hot water temperature, press the [Dispense] button once. Hot water will be dispensed at the selected temperature.
 - ▶ Pressing the [Dispense] button or any other button during hot water dispensing will stop the dispensing process.



※ 온수온도 레벨





To Dispense a Fixed Volume of Water

- 1 The fixed volume changes every time you turn the [Jog Dial].
 - ▶ e.g. In EASY mode: Half cup → One cup → Two cups → Non-stop → Favorite flow → Repeat
 - ▶ Favorite flow allows users to set and use their preferred flow. Refer to page 22 for details on how to change the favorite flow.
- 2 After selecting the desired fixed volume, press the [Dispense] button to dispense water at the selected volume.
- 3 You can set the desired Flow Mode in the Flow Mode Settings function. Refer to page 22 for details on how to use Flow Mode.

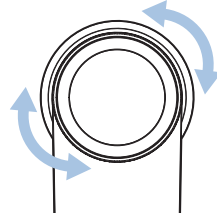

To Use Cleaning Water

- 1 Press the [Cleaning Water] button to select cleaning water.
 - ▶ Press [Cleaning Water] and the Cleaning Water function screen will appear.
 - ▶ The voice guide will say, "Cleaning Water Dispensing mode."
 - ▶ Turn the [Jog Dial] to select the desired volume of cleaning water, and press the [Dispense] button. The desired volume of cleaning water will be dispensed.
- 2 To End Cleaning Water Dispensing
 - ▶ Pressing the [Dispense] button or any other button during cleaning water dispensing will stop the dispensing process.
 - ▶ After cleaning water dispensing ends, the flow path pipe cleaning will start. The voice guide will say, "Cleaning the flow path. Please wait."
 - ▶ The voice guide will say, "Flow path cleaning completed" when finished.

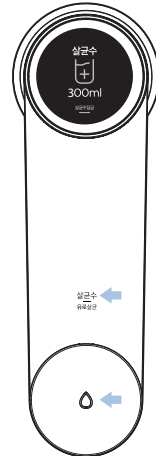

※ How to properly sterilize fruits and vegetables

- ▶ Remove foreign substances such as dirt before cleaning, and soak in cleaning water for approximately 5 minutes.
- ▶ Rinse with clean water at least 3 times to remove cleaning water after use.

- ※ Cleaning water is not for drinking. Please do not consume cleaning water. (As Cuckoo In&Out cleaning water is managed under the Management of Drinking Water Act, it is safe if ingested. However, please refrain from drinking it.)
- ※ For maximum cleaning effects, please use the dispensed cleaning water after 10 seconds. (Cleaning water dispensed within 10 seconds may have an insufficient cleaning effect.)



How to Use

To Use the Instant Auto Cleaning Function

This function is used to start auto-cleaning at a chosen time.

▶ The cleaning method and duration are the same as the Auto Cleaning function.

- 1 Press and hold the [Cleaning Water] button for 3 seconds in Standby mode.
 - ▶ Instant Automatic cleaning will start, and the voice guide will say, "Starting flow path cleaning."
 - ▶ The cleaning image will be displayed on the LCD screen, and cleaning progress will be indicated.
 - Progress is shown on the LCD screen.
- 2 To cancel cleaning, press the [LCD Central] button for 3 seconds during auto cleaning.
 - ▶ The voice guide will say, "Stopping flow path cleaning," and cleaning will be canceled.
 - ▶ In some cases, subsequent processes may follow, such as draining cleaning water, rinsing, and intake. It will take some time to return to Standby mode for water dispensing.

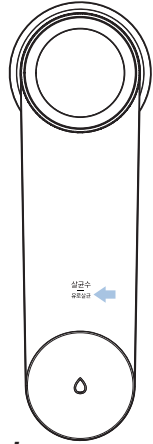

To Use Instant Electrolysis Cleaning and Steam Cleaning

- 1 Place the cleaning cup.
 - ▶ Rotate the cleaning cup to match the dispensing outlet of the faucet as indicated by the reference line on the right image.
 - * If the cleaning cup is higher than the reference line, it may be difficult to place the cup.
- 2 When the cleaning cup is detected, you can swipe left or right to select electrolysis cleaning or steam cleaning.
 - ▶ If you select [Electrolysis Cleaning]
 - Electrolysis faucet cleaning starts and the voice guide will say, "Starting faucet cleaning."
 - ▶ If you select [Steam Cleaning]
 - Steam cleaning starts, and the voice guide will say, "Starting steam cleaning."
 - ▶ The cleaning image will be displayed on the LCD screen, and cleaning progress will be indicated.
- 3 To cancel cleaning, press the [LCD Central] button for 3 seconds during faucet cleaning.
 - ▶ The voice guide will say, "Stopping steam or faucet cleaning," and cleaning will be canceled.
 - ▶ When faucet cleaning is canceled, do not remove the cleaning cup as water will be dispensed to clean the faucet.
 - * Please remove the cleaning cup after the machine has stopped operation.

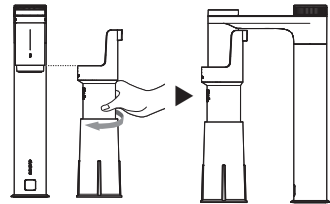

좌우
드래그

- * Cleaning water is not for drinking. Please do not consume cleaning water.
- * You may steam clean the product once a day.
- * Need caution as steam cleaning can be hot and may cause burns.
- * Water droplets may form on the front of the product after steam cleaning.



To Use the Hidden Display Function

This function is used to save power. The display panel will be turned off and the brightness of the display lamps will be reduced.

1 To Enter Hidden Display Mode

- ▶ After 15 seconds of no button input and no detection of the presence of a human in Standby mode.
- ▶ You can change access time for entering the mode in User Settings mode. (Refer to "LCD Sleep Time" on page 25)

2 To Exit Hidden Display Mode

- ▶ When the presence of a human is detected in Hidden Display mode
- ▶ When a button is pressed in Hidden Display mode
 - ※ Water is immediately dispensed if the [Dispense] button is pressed in Hidden Display mode.
 - ※ The human detection sensor will operate if you approach the product from the front. (Sensor sensitivity may vary depending on the installed environment.)

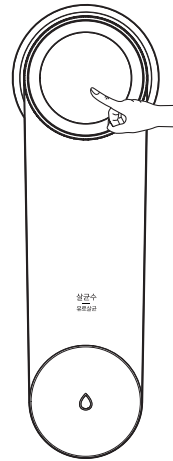

To Use the Full Lock Function

This function is used to prevent random control by children and others or to clean the product. If this function is enabled, all button input will be blocked.

1 Swipe up (down→up) on the Room Temperature Water function screen to enter Full Lock Settings mode.

- ▶ After entering Full Lock Settings mode, swipe left or right to select Enable Full Lock, and press the [LCD Central] button to enable Full Lock.
- ▶ If you select Disable Full Lock in Full Lock and press the [LCD Central] button, Full Lock will be disabled.





How to Use

To Change Favorite Flow

- 1 Swipe down (up→down) on the Room Temperature Water function or Cold Water function screen to enter Option Settings mode.
- 2 When Entering User Settings mode
 - ▶ The voice guide will say, "Favorite Flow Settings mode."
- 3 Press the [LCD Central] button to enter the Favorite Flow Settings mode.
- 4 Swipe left or right, or use the [Jog Dial] to set the favorite flow.
 - ▶ Each left/right swipe changes the flow by 10 ml.
 - e.g. Swipe left: 350 ml → 360 ml → 370 ml → . . . → 1500 ml
 - Swipe right: 350 ml → 340 ml → 330 ml → . . . → 100 ml
- 5 Select the desired flow and press the [LCD Central] button to save.
 - ▶ The voice guide will say, "Setup complete."



To Change Flow Mode Settings

- 1 Swipe down (up→down) on the Room Temperature Water function or Cold Water function screen to enter Option Settings mode.
- 2 Swipe left (right→left) once in Option Settings mode and select Flow Mode Settings mode.
 - ▶ The voice guide will say, "Flow Mode Settings mode."
- 3 Press the [LCD Central] button to enter Flow Mode Settings mode.
- 4 Swipe left or right, or use the [Jog Dial] to set the Flow mode function.
 - ▶ Each left/right swipe changes the set value.
 - e.g. EASY → SMART → CHEF → . . .
- 5 Select the desired Flow mode and press the [LCD Central] button to save.
 - ▶ The voice guide will say, "Setup complete."



※ Mode details

- 1) EASY: Half cup (120 ml), one cup (250 ml), two cups (500 ml), non-stop (1500 ml)
- 2) SMART: 120 ml → 200ml → 250 ml → 350 ml → 500 ml → 550 ml → 850 ml → 1000 ml → 1500 ml
- 3) CHEF: 100 ml → 150 ml → 200 ml → . . . → 1000 ml → 1100 ml → . . . → 1500 ml
(Increases by 50 ml from 100 ml to 1000 ml, and by 100 ml from 1000 ml to 1500 ml)



To Adjust Voice Volume

- 1 Swipe down (up→down) on the Room Temperature Water function or Cold Water function screen to enter Option Settings mode.
 - ▶ The voice guide will say, "Voice Volume Settings mode."
- 2 Swipe left (right→left) 2 times in Option Settings mode and select Voice Volume Settings mode.
 - ▶ The voice guide will say, "Voice Volume Settings mode."
- 3 Press the [LCD Central] button to enter the Voice Volume Settings mode.
- 4 Swipe left or right, or use the [Jog Dial] to adjust the volume level of the voice.
 - ▶ Each left/right swipe changes the volume level by one from the current level.
e.g. Level 5 → Mute mode → Button sound → Level 1 → Level 2 → Level 3 → Level 4 → Level 5
 - ▶ To set the maximum volume, select 5 as the Settings value.
 - ▶ If you do not want to use the voice guide, select Mute mode or Button sound.
- 5 Select the desired voice volume and press the [LCD Central] button to save.
 - ▶ The voice guide will say, "Setup complete."



To Use the Mood Lamp Function

- 1 Swipe down (up→down) on the Room Temperature Water function or Cold Water function screen to enter Option Settings mode.
 - ▶ The voice guide will say, "Mood Lamp Settings mode."
- 2 Swipe left (right→left) 3 times in Option Settings mode and select Mood Lamp Settings mode.
 - ▶ The voice guide will say, "Mood Lamp Settings mode."
- 3 Press the [LCD Central] button to enter the Mood Lamp Settings mode.
- 4 Swipe left or right, or use the [Jog Dial] to set the Mood Lamp function.
 - ▶ Each left/right swipe changes the set value.
e.g. ON → OFF → ON
- 5 After selecting the Mood Lamp function, press the [LCD Central] button to save.
 - ▶ The voice guide will say, "Setup complete."



※ When the Mood Lamp function is turned off, the LED on the [Jog Dial] will turn off.



How to Use

To Use the Auto Filter Cleaning Function

- 1 Swipe down (up→down) on the Room Temperature Water function or Cold Water function screen to enter Option Settings mode.
 - ▶ Swipe left (right→left) 4 times in Option Settings mode and select Auto Filter Cleaning mode.
 - ▶ The voice guide will say, "Auto Filter Cleaning function."
- 2 Press the [LCD Central] button.
 - ▶ The voice guide will say, "Starting Auto Filter cleaning," and auto filter cleaning will start.
 - ▶ The filter cleaning image will be displayed on the LCD screen, and the filter cleaning progress will be shown.
- 3 When Auto Filter Cleaning is complete, the voice guide will say, "Auto Filter Cleaning complete," and the product will enter Standby mode for water dispensing.
- 4 To cancel Auto Filter Cleaning, press the [LCD Central] button for 3 seconds during auto filter cleaning.
 - ▶ The voice guide will say, "Stopping Auto Filter Cleaning."
- 5 The Auto Filter Cleaning takes approximately 10 to 15 minutes. Time varies depending on tap water pressure.
 - ▶ When the voice guide says, "Check the tap water intake" while the filter is being cleaned, open the filter door cover on the front of the product and turn the lock lever to the CLOSE direction.



To Change the LCD Screen Rotation

- 1 Swipe down (up→down) on the Room Temperature Water function or Cold Water function screen to enter Option Settings mode.
- 2 Swipe left (right→left) 5 times in Option Settings mode and select LCD Screen Rotation Settings mode.
 - ▶ The voice guide will say, "LCD Screen Rotation Settings mode."
- 3 Press the [LCD Central] button to enter the LCD Screen Rotation Settings mode.
- 4 Swipe left or right, or use the [Jog Dial] to adjust the LCD screen angle.
 - e.g. 0 degrees → 90 degrees → -90 degrees
- 5 After selecting the screen angle, press the [LCD Central] button to save.
 - ▶ The voice guide will say, "Setup complete."





To Change the LCD Sleep Time

- 1 Swipe down (up→down) on the Room Temperature Water function or Cold Water function screen to enter Option Settings mode.
- 2 Swipe left (right→left) 6 times in Option Settings mode and select Screen Sleep Time Settings mode.
▶ The voice guide will say, "LCD Sleep Settings mode."
- 3 Press the [LCD Central] button to enter the Screen Sleep Time Settings mode.
- 4 Swipe left or right, or use the [Jog Dial] to adjust the LCD sleep time.
▶ Each left/right swipe changes the LCD sleep time. e.g. 30 seconds → 60 seconds → 15 seconds → 30 seconds
- 5 After selecting the LCD sleep time, press the [LCD Central] button to save.
▶ The voice guide will say, "Setup complete."



To Change the Dispensing Volume

- 1 Swipe down (up→down) on the Room Temperature Water function or Cold Water function screen to enter Option Settings mode.
- 2 Swipe left (right→left) 7 times in Option Settings mode and select Flow Correction Value Settings mode.
▶ The voice guide will say, "Flow Correction Value Settings mode."
- 3 Press the [LCD Central] button to enter the Flow Correction Value Settings mode.
- 4 Swipe left or right, or use the [Jog Dial] to set the flow correction value.
▶ Each left/right swipe changes the flow correction value.
e.g., 5% (dispensing volume increased) → 10% → -10% → -5% (dispensing volume decreased) → 0%
- 5 After selecting the flow correction value, press the [LCD Central] button to save.
▶ The voice guide will say, "Setup complete."



To Drain the Refrigerant Water

- 1 Swipe down (up→down) on the Room Temperature Water function or Cold Water function screen to enter Option Settings mode.
- 2 Swipe left (right→left) 8 times in Option Settings mode and select Refrigerant Water Draining mode.
▶ The voice guide will say, "Draining function."
- 3 Press the [LCD Central] to enter the Refrigerant Water Draining function.
- 4 When entering Refrigerant Water Draining mode, refrigerant water will be automatically drained.





How to Use

Auto Cleaning Cycle Settings Function

- 1 Swipe down (up→down) on the Room Temperature Water function or Cold Water function screen to enter Option Settings mode.
- 2 Swipe left (right→left) 9 times in Option Settings mode and select Cleaning Cycle Settings mode.
▶ The voice guide will say, "Cleaning Cycle Settings mode."
- 3 Press the [LCD Central] button to enter the Cleaning Cycle Settings mode.
- 4 Swipe left or right, or use the [Jog Dial] to adjust the cleaning cycle.
▶ Each left/right swipe changes the cleaning cycle.
e.g. 5 days → 7 days → 10 days → OFF → 3 days → 5 days
- 5 After selecting the cleaning cycle, press the [LCD Central] button to save.
▶ The voice guide will say, "Setup complete."
※ When Auto Cleaning is turned off, the Automatic Cleaning function will be disabled.



To Enable the Cleaning Module Replacement Notification Function

- 1 Swipe down (up→down) on the Room Temperature Water function or Cold Water function screen to enter Option Settings mode.
- 2 Swipe left (right→left) 10 times in Option Settings mode and select Cleaning Module Replacement Notification Settings mode.
▶ The voice guide will say, "Cleaning Kit Module Replacement Notification mode."
- 3 Press the [LCD Central] button to enter Cleaning Module Replacement Notification Settings mode.
- 4 Swipe left or right, or use the [Jog Dial] to set the Cleaning Module Replacement Notification function.
▶ Each left/right swipe toggles between ON and OFF.
e.g. ON → OFF → ON → OFF → ...
- 5 After selecting ON/OFF for the cleaning module usage notification, press the [LCD Central] button to save.
▶ The voice guide will say, "Setup complete."
※ When the function is turned off, cleaning module usage notifications will not be provided.





To Set the Filter Replacement Alarm Function

- 1 Swipe down (up→down) on the Room Temperature Water function or Cold Water function screen to enter Option Settings mode.
- 2 Swipe left (right→left) 11 times in Option Settings mode and select Filter Replacement Notification Settings mode.
▶ The voice guide will say, "Filter Replacement Notification mode."
- 3 Press the [LCD Central] button to enter Filter Replacement Notification Settings mode.
- 4 Swipe left or right, or use the [Jog Dial] to set the Filter Replacement Notification function.
▶ Each left/right swipe toggles between ON and OFF.
e.g. ON → OFF → ON → OFF → ...
- 5 After selecting ON/OFF for the filter replacement notification, press the [LCD Central] button to save.
▶ The voice guide will say, "Setup complete."
※ When the function is turned off, filter replacement notifications will not be provided.



To Enable LCD Central Button Dispensing Function

- 1 Swipe down (up→down) on the Room Temperature Water function or Cold Water function screen to enter Option Settings mode.
- 2 Swipe left (right→left) 12 times in Option Settings mode and select LCD Central Button Settings mode.
▶ The voice guide will say, "LCD Central Button Dispensing Function Settings mode."
- 3 Press the [LCD Central] button to enter the LCD Central Button Settings mode.
- 4 Swipe left or right, or use the [Jog Dial] to adjust the LCD Central button function.
▶ Each left/right swipe toggles between ON and OFF.
e.g. Dispensing ON → Dispensing OFF → ...
- 5 After selecting ON/OFF for the LCD Central Button function, press the [LCD Central] button to save.
▶ The voice guide will say, "Setup complete."
※ When the function is turned off, the [LCD Central] button cannot be used for dispensing.





How to Use

How To Set Language

- 1 Swipe down (up→down) on the Room Temperature Water function or Cold Water function screen to enter Option Settings mode.
- 2 Swipe left (right→left) 13 times in Option Settings mode and select Language Settings mode.
 - ▶ The voice guide will say, "Voice selection mode."
- 3 Press the [LCD Central] button to enter the Language Settings mode.
- 4 Swipe left or right, or use the [Jog Dial] to adjust the Language.
 - ▶ Each left/right swipe changes the Language.
e.g. English → Cantonese → Mandarin
- 5 After selecting the Language, press the [LCD Central] button to save.
 - ▶ The voice guide will say, "Setup complete."





How to Clean

1 Wipe with a soft dry cloth.

- ▶ Before cleaning, set the Button Lock function to prevent an incorrect operation during cleaning.
- ▶ If the product becomes severely polluted, wipe it out with a cloth with a little moisture. (Do not clean the product by using benzene, thinner, or abrasive.).
- ▶ When cleaning the product, do not spray water directly on the product. (This may cause product failure.)

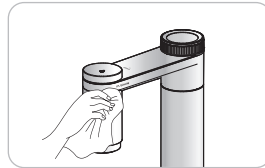
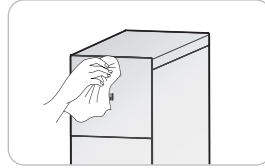

2 Pull the pre-filter on the bottom to separate it from the main body, rinse it under running water, dry it, and reassemble the product.

- ▶ Failure to clean the pre-filter for a long period of time may result in decreased performance of the Cold Water function.

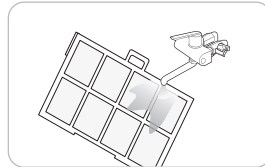



How To Replace the Filters

How To Replace the Filters (Must not use non-CUCKOO Water Purifier filters.)

※ The filter door detection sensor is in operation so, when replacing the filter, do not pull the power cord.

- 1 Pull the filter door forward to open as shown in the image.

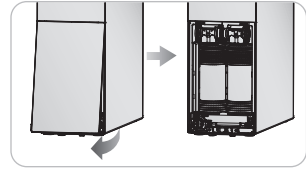

- 2 Turn the filter guide bracket lock lever on the front of the product to the OPEN direction, as shown in the image.

▶ It shuts off the water supply to prevent water from flowing during filter replacement.

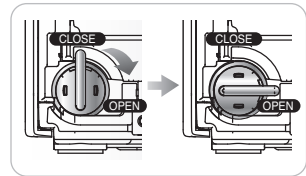

- 3 As shown in the image, pull the filter guide bracket down.

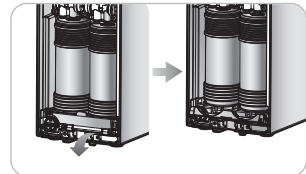

- 4 Lift and pull the filter to remove it.

▶ While the Voice Guide plays, any pressure remaining inside the pipe is removed.
▶ During filter replacement, water drops may fall depending on the user environment. Please wipe out any water after replacement.

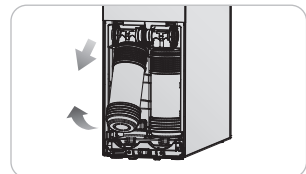



How To Replace the Filters (Must not use non-CUCKOO Water Purifier filters.)

- 5 Insert the filter as shown in the image and push it into the filter case to connect.
- ▶ The order of the filters is Metal Block 2.0 and Nano Positive Plus 3.0, from the left. Please be mindful of the order.
 - ▶ Check if the filters are properly installed in the filter case.

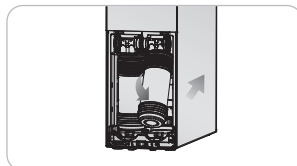

- 6 As shown in the image, pull the filter guide bracket up.

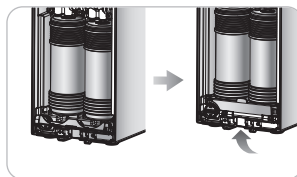

- 7 Turn the filter guide bracket lock lever on the front of the product to the CLOSE direction, as shown in the image.
- ▶ Water is supplied to the water purifier.

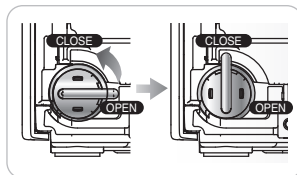

- 8 Lock the filter door as shown in the image. (Regarding the Auto Filter Cleaning feature, refer to page 24.)
- ▶ The groove at the top must be accurately aligned for smooth installation.

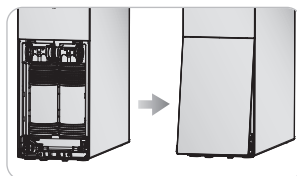

- 9 Once the product enters the Standby mode, use the Auto Filter Cleaning feature to clean the filter. (Regarding the Auto Filter Cleaning feature, refer to page 24.)

※ When the Voice Guide says, "Check the tap water intake," while the filter is cleaned, turn the lock lever of the filter door on the front of the product to the CLOSE direction.



Expected Filter Replacement Cycle / Recommendations / Filter Arrangement

Expected Filter Replacement Cycle

- ▶ The filter replacement cycle is determined based on usage of 10L per day in a common household, and may be affected by the state of the source water.

Filter Name	Expected Replacement Cycle
Metal Block 2.0 Filter	4 months
Nano Positive Plus 3.0 Filter	8 months

Recommendations

▶ Filter Replacement Cycle

- Filter replacement cycle refers to a period during which a filter is expected to demonstrate its inherent performance as a result of a thorough review of the filter.

This is based on tap water where the inflow water and daily usage

Filter Arrangement

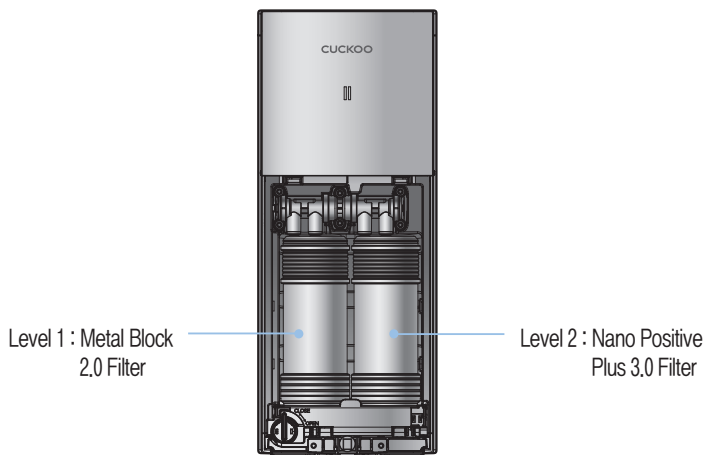

Please check before asking for Support

▼ If you do not comply with this User Manual, the product may not work properly even if there is no malfunction. Please take the following measures accordingly if there is a problem with the product. If there is still a problem, please contact our Customer Service Center.

Problem	Checklist	Recommended Actions
The water has bad taste and/or odor.	<ul style="list-style-type: none"> • Was the product left idle for a long time? • Do you need to replace the filters? 	<ul style="list-style-type: none"> • Operate the Filter Cleaning function. (Refer to page 24) • Contact Customer Service for filter replacement.
It fails to dispense water.	<ul style="list-style-type: none"> • Is the Power Cord connected? • Is the tap water supplied properly? • Have you pressed the [Outflow] button properly? • Is there water under the product? • Do you need to replace the filters? • Is the Filter Door lock opened? 	<ul style="list-style-type: none"> • Connect the Power Cord. • Open the Tap Water Supply Valve. • Check if the water supply tube is folded. • Check if water is cut off. • Press the [Outflow] button properly. • Close the Tap Water Supply Valve, unplug the product, and contact our Customer Service Center. • Contact Customer Service for filter replacement. • Close the Filter Door lock on the front of the product. (Water is supplied to the product)
It fails to dispense cold water.	<ul style="list-style-type: none"> • Have you dispensed a lot of cold water? • Did you close the Tap Water Supply Valve? • Is the ventilation at the back of the product good? 	<ul style="list-style-type: none"> • If a lot of cold water is dispensed, the product needs some time to recool the water. • Check the Tap Water Supply Valve. • Check if the radiator at the back of the product is blocked. Remove any objects blocking the radiator. • Move the product to a place with good ventilation. (Please contact our Customer Service Center whenever you move and reinstall the product.) • If there is excess dust in the air vents, contact our Customer Service Center.
The hot water is lukewarm.	<ul style="list-style-type: none"> • Is it the first cup of hot water? 	<ul style="list-style-type: none"> • When you first operate the Instantaneous Hot Water function, the temperature of the first cup may be low. • Check if the temperature of the hot water is normal from the second cup.

Please check before asking for Support

- ▼ If you do not comply with this User Manual, the product may not work properly even if there is no malfunction. Please take the following measures accordingly if there is a problem with the product. If there is still a problem, please contact our Customer Service Center.

Problem	Checklist	Recommended Actions
It does not dispense enough water.	<ul style="list-style-type: none"> • Have you closed the Tap Water Supply Valve? • Do you need to replace the filters? • Is the Filter Door lock opened? 	<ul style="list-style-type: none"> • Open the Tap Water Supply Valve. • Replace the Filter with a genuine CUCKOO Filter. • Close the Filter Door lock on the front of the product. (Water is supplied to the product)
There is a loud noise coming from the product.	<ul style="list-style-type: none"> • Please check if it's installed on firm, even ground. • Does it touch any other objects? • Is the Tray assembled properly? • Are the back surface and the side surfaces of the product in contact with the wall? • Are there items such as a flowerpot, books, or clock on the product? 	<ul style="list-style-type: none"> • Install the product on a flat and solid floor. • Make sure it does not touch any other objects. • If the Tray is not properly mounted, an abnormal noise can be made. Check the state of assembly of the Tray. • Reinstall the product with a proper distance (20 cm)/from the wall. • Remove the items on the product.
There are floating matters in the dispensed water.	<ul style="list-style-type: none"> • Do you need to replace the filters? 	<ul style="list-style-type: none"> • Replace the Filter. (Do not use a Non-Cuckoo filter.)
There are fine particles in the room water.	<ul style="list-style-type: none"> • Are there bubbles? 	<ul style="list-style-type: none"> • If there are still fine particles in the water after five minutes, immediately contact our Customer Service Center.
Water is leaking from the purifier.	<ul style="list-style-type: none"> • Is the assembled (connecting) part defective? • Is your home or the external environment humid? 	<ul style="list-style-type: none"> • Close the Tap Water Supply Valve and unplug the product. After that, contact our Customer Service Center for service. • Dew condensation may occur when a cold part of the water purifier meets moisture, which is the same as if a water droplet forms on a water cup.

Product Specifications

Product Name		Electric Water Purifier (Other Liquid Heater) Cuckoo Cold/Hot/Room Temperature Water Purifier	
Item Name		Water Purifier	
Model Name		CP-AAN100ULW (LUMI WHITE)	
Rated Voltage		Single Phase AC 220-240V~ / 50 Hz	
Power Consumption		Cold water 0.6A, Hot water 2400W	
Filtration		Electrostatic adsorption filtration system	
Filter Category		Metal Block 2.0 Filter	Nano Positive Plus 3.0 Filter
Filter Material		Polypropylene, compressed activated carbon	Polypropylene, cellulose, activated carbon, compressed activated carbon, polyethersulfone
Filter Replacement Cycle		4 months	8 months
Capacity	Room Temperature Water	Direct water	
	Cold Water	Direct water	
Climate Class		T (temperate climate)	
Product	Main body	Weight	Approx. 11.0 kg
		Size (W×D×H)	166mm×390mm×418mm
	Faucet	Weight	Around 0.9 kg
		Size (W×D×H)	61mm × 187mm × 306mm
Used Tap Water Pressure		0.07 ~ 0.69 MPa (0.7 ~ 6.9bar)	
Used Environment Temperature		5 ~ 40°C	
Used Tap Water Temperature		5 ~ 35°C	

※ Details indicated in this Instruction Manual (exterior, design, and specifications) may change without notice for quality improvement.

※ Manufacturer: Cuckoo HomeSys Co., Ltd.



MEMO



各位顧客!

感謝各位購買CUCKOO IN & OUT 淨水濾水器
請好好保管此使用說明書(包含保養證書)
使用上有疑難又或是出現功能運作問題時可助解除疑難

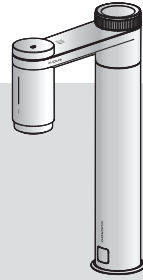

CUCKOO IN & OUT 淨水濾水器的特徵與優點

優點

- **NANO POSITIVE 過濾系統**
使用CUCKOO濾水器的NANO POSITIVE 過濾系統，可以為你提供純淨、健康同時含有礦物質的飲用水
- **健康的淨水濾水器**
通過濾芯以即時冷凍、加熱、濾水的方式，馬上可以飲用冰水、熱水、淨水
- **超薄設計同時擁有多種功能的新穎濾水器**
集冷水、溫水、濾水、殺菌等功能於一身的濾水器，超薄又新穎的設計，更節省使用空間。
- **電解殺菌系統**
使用電解殺菌系統令濾水器更加衛生，讓一般水管水直接導出為殺菌水，食材及廚房用殺菌更為方便。
- **經濟型環保濾水系統**
通過NANO POSITIVE濾芯，水源通過的過程中沒有浪費任何用水，是非常經濟又環保的濾水系統。
- **按鈕鎖定/功能鎖定**
為了防止兒童及老弱者錯誤使用而導致意外，增加了按鈕鎖定及功能鎖定(溫水、殺菌水)。
- **防止漏水系統**
濾水器可以感應/阻止使用產品時發生的漏水，更加安全。
- **可以連續出水**
可以持續出冷水、熱水、濾水，便利方便。
- **可以定量出水**
冷水、熱水、濾水均可設定一杯(約250cc)，半杯(約120cc)定量出水，更加方便

使用說明書中包含保養證書

在使用產品前，務必閱讀使用說明書以正確使用產品閱讀後，請放在使用者通常看到的地方保管。
注意:本產品為家庭用品，不建議其他使用用途(商業用、實驗用等)，為了避免故障、令產品使用時間更長久，請在使用前閱讀使用說明書。

CONTENTS(目錄)

使用前	● CUCKOO IN & OUT 淨水濾水器的特徵與優點	38
	安全性警告	40~43
	安全注意	44~45
	各部分的名稱/配件介紹	46~47
使用的時候	● 濾水處理系統	48
	產品安裝方法	49
	使用前確認事項	50
	使用	51~64
	清潔方法	65
	濾芯更換方法	66~67
	濾芯更換周期/建議事項/濾芯排列圖	68
故障申報前	● 故障申報前請確認	69~70
服務指南	● 產品規格	71



安全性警告

- ‘安全上的警告’ 為了防止意外及危險，請安全及正確地使用產品。
- ‘安全上的警告’ 分為 ‘警告’ 及 ‘注意’ 兩部分，‘警告’ 及 ‘注意’ 的意義如下。

<p>警告</p> <p>如果不可避免的話可能會導致死亡或重傷等潛在危險狀況</p>	<ul style="list-style-type: none"> • 這個標示是提醒，在特定條件下有可能會導致危險的事項，要注意空氣流通的標示。 • 為了避免發生危險，高度注意並根據指示使用。
<p>注意</p> <p>如果不可避免的話可能會導致的潛在危險狀況</p>	<ul style="list-style-type: none"> • 這個標示是 ‘禁止’ 某些行為的標示。 • 這個標示是 ‘指示’ 某些行為的標示。

電源相關問題

警告 **禁止**

只能用於有接地的標準規格13 A以上的交流220-240V專用插座，請勿在一個插座上同時插上電源及使用幾種產品。

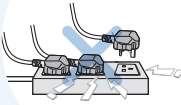

- 如與多種產品使用時，可能會引發火災及觸電。請不時確認插座狀態。
- 如接地不正確，可能會導致因漏電引起的觸電。
- 如接地插頭沾上異物或水氣，請拭擦乾淨後使用。

如電線或電源插頭有損壞或插座有異動，請停止使用，並諮詢客服。



- 在使用產品過程中，如果因使用不慎導致電線的包覆剝落或剝損，可能會引起火災及觸電，請不時確認電線、電源插頭及插座的狀態。
- 為防止電線或電源插頭的損壞構成危險，請由製造商、其銷售點或合資格技師(售後服務技師)更換插頭。
- 請務必於指定的服務中心進行修理。
- 可能會引發觸電、漏電及火災。

禁止強行彎曲、捆綁、拽拉電源線。

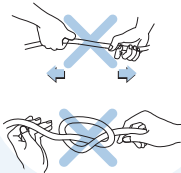

- 可能因觸電或短路引起火災。請隨時確認電源插頭的狀態。

如電源插頭沾上水、灰塵、異物等，請用乾布擦拭乾淨。



- 可能會引發觸電、休克及起火。請務必不時確認電源插頭的狀態。

請勿使用黏附式多功能插座。



- 可能會引起火災及觸電。

如使用移動型延長插座，請於電流量為13A，有接地的延長插座使用單一產品。

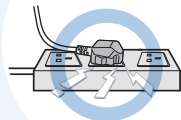

- 可能會引發火災及觸電。



電源相關問題

警告

禁止

在拔開電源插頭時，請勿拽拉電線而是要抓住電插頭。

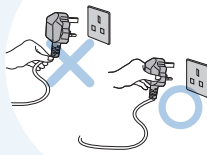

- 如果電線受到撞擊，可能會引發觸電及火災。請務必隨時確認電源插頭及電源線的狀態。

請勿使用交流220-240V以外的電源

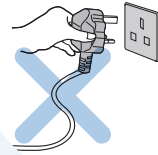

- 可能會引發觸電及火災。
- 產品不能正常運作。
- 請務必隨時確認電源插頭及電源線的狀態。

漏水及清洗(清潔)時請務必關閉水源供應閥後將插頭拔出。

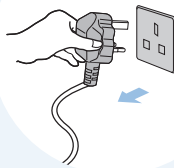

- 可能導致觸電及故障。請務必隨時確認電源插頭及電源線的狀態。

將電源插頭插入或拔出插座時，請務必先去除手上的水氣，方可抓住電源插頭插入或拔出。

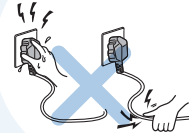

- 用濕手拔掉電源插頭可能會引發觸電。
- 強行拉拔可能會引致電源插座發生異常，引起漏電及觸電。請務必隨時確認電源插頭及電源線的狀態

請確保電線不被重物壓住或接觸到鋒利的地方，注意避免被寵物損壞電線。

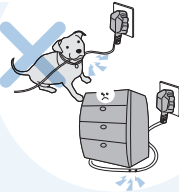

- 可能因插頭損壞引起觸電或火災。請務必隨時確認電源插頭的狀態。

長時間不使用產品時，請將水源供應閥關閉，將冷卻水箱內的水完全倒出，將電源插頭拔出。

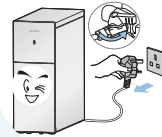

- 再次使用時，請填滿一次水後清空使用，或啟動即時殺菌功能使用。
- 再次使用時，請參考“使用前確認事項”。(第50頁)

產品維修、檢修及配件更換過程中，請務必拔掉電源插頭

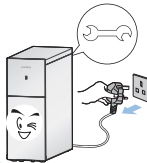

- 存在故障或觸電危險。請務必隨時確認電源插頭及電源線的狀態。

電源部分進水時，請拔掉插頭，完全瀝乾後再使用。

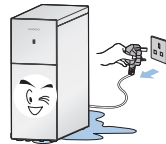

- 可能會引發觸電及火災。請務必隨時確認電源插頭及電源線的狀態。



安全性警告

安裝相關內容



警告



禁止

請勿安裝在灰塵多或溫度變化大(如室外、塑膠棚等)和會直接接觸到水的地方



- 請將產品安裝在乾淨衛生的環境中。
- 否則可能引發產品故障、觸電和火災。

請勿安裝於近洗手間的地方。

請勿安裝於凹凸不平或傾斜的地方，請勿安裝於墊板、坐墊、地板紙、絨毯或地毯上。

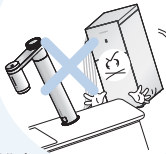

- 可能引起故障及噪音，並可能造成傷害。請不時確認產品狀態。
- 可能會發生火災及產品破損。

安裝時請避免光線直射及高溫。

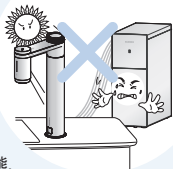

- 可能導致變色及掉色。
- 請務必不時確認電線插頭的狀態。

連接於產品的水源供應喉長度應安裝於從水源供應閥5m以下。

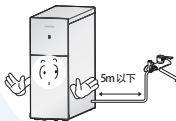

- 可能引起產品性能下降。

請安裝於離牆壁20cm以上的距離，地面堅固及平坦的地方。

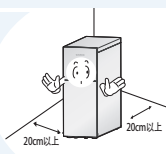

- 可能引起產品性能下降。

請勿安裝於可能有氣體洩漏或靠近冷氣機、暖爐的地方。

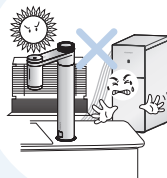

- 存在爆炸或火災危險。

請務必使用自來水，將水源供應閥安裝於冷水管一側。



- 請勿使用自來水以外的地下水等作為水源
- 濾芯更換時期可因地區、用水量等造成差異。
- 安裝於溫水管路可能導致過濾器損壞及產品故障。

請避免安裝於周圍溫度下降至5°C以下的地方或室外。



- 過濾器及管線，產品內部結冰
- 可能導致產品故障或漏水。
- 產品的使用環境溫度為5°C~40°C。

請勿將連接產品的拉排水喉安裝高於產品安裝面，或距離淨水器多於3m。

- 排水功能可能不暢順。

如將排水喉纏及廚房等地面連接排水口，請勿提高於地面30cm以上。

- 排水功能可能不暢。



使用中



警告



禁止

請勿將微波爐、電烤箱、烤麵包機等發熱電器放於產品上，請勿將蠟燭、煤氣罐、打火機等易燃物放於產品上。

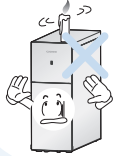

- 存在火災及觸電、安全事故的危險。

請勿將藥品、水桶、小金屬等放於產品上。



- 進入產品內部可能會引起火災危險及產品

移動產品時，請不要拉扯電源插座及連接喉，或抓住出水口部位。



- 可能引起產品破損。

請勿分拆或改造產品。



- 可能引起火災及觸電。
- 請勿讓服務技師以外的人進行分拆或回收。

本機器不適合身體、感覺、精神能力不足，或缺乏經驗和知識，沒有監督或指示下無法安全使用機器的人士(包括兒童)使用。



- 請注意不要讓兒童玩機器。
- 可能引起觸電或受傷。

※ 殺菌水不是飲用水，請注意不要飲用殺菌水

※ 殺菌水用於水果類、蔬菜類、器具類等殺菌，請用烹飪水清洗。



警告



指示

如果產品內部有水流或周邊有積水，請關閉水源供應閥，關上電源及拔出電源插頭後聯繫客服中心。



- 存在觸電危險。

如果產品傳出燒焦的氣味或出煙，請立即拔出電源插頭，關閉水源供應閥後聯繫客服中心。

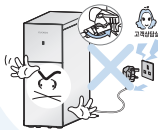

- 存在火災危險。

使用熱水及溫水時請注意。



- 溫水(熱水)可能會濺出，請注意不要接觸到身體。(特別老弱者及兒童使用時需要注意。)
- 暫停或結束出溫水(熱水)後，出水口可能仍會有水滴出，請確認後取走杯子。

產品安裝及拆卸時請通過客服聯絡服務技師安裝及拆卸。

請注意不要讓兒童等過於頻繁地使用控制面板。

- 可能引起產品故障及安全事故。

更換濾芯時請關閉水源供應閥(連接器)。(水源供應閥通常在洗滌槽下或水龍頭內)。



- 存在漏水危險。

請勿讓針、清潔用針、金屬物等異物進入或堵塞吸氣口及排氣口。

- 可能引起火災及觸電。



安全注意

警告

指示

請徹底關上產品內部的冷卻水箱蓋及產品上蓋後使用。

- 異物可能進入。



請按照更換週期更換濾芯。

- 可能導致淨水性能下降及產生異味。
- 濾芯更換週期請參考第68頁。



長時間未使用時，請進行1次即時自動殺菌功能後使用。

- 可使用即時殺菌功能簡單清洗喉管及冷卻水箱。(參考第56頁)

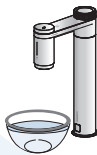

城市煤氣、丙烷等氣體洩漏時請不要拔掉產品電源，即時打開窗戶通風。

- 可能引起火災及觸電。



請勿將濾水器水用於魚缸或水族館等處換水。

- 過濾水可能不適合魚類環境。根據情況可能導致魚類死亡。

移動產品時請勿傾斜 30° 以上。

- 可能導致產品性能下降。

請務必使用Cuckoo正版濾芯。

- 使用Cuckoo正版濾芯以外的濾芯可能引致淨水功能下降，水味異常及漏水、產品故障。

LCD觸控區域與水龍頭上端有水氣時，請去除水氣後再使用。

- 否則可能導致產品功能下降及故障。

警告

禁止

請勿使用苯、溶劑等清潔產品。

- 可能引致產品損傷

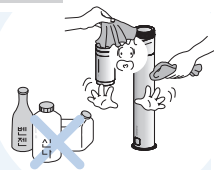

機器運轉時請勿移動產品。

- 請勿在連接電源的狀態下移動或搖晃產品。可能因連接喉管脫落引致產品故障及漏水。

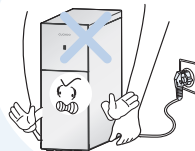

產品使用時請勿拔掉產品背面的喉管。

- 可能因漏水引致產品故障。

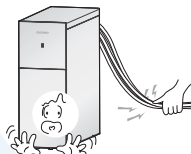

請勿在產品上放置磁性物體。

- 否則可能導致產品故障。

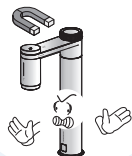



警告

請確保兒童無法接觸發泡膠、塑膠等包裝物料。



- 可能引致窒息。

請勿將水源入口管連接於自來水(食水)以外的其他水管。

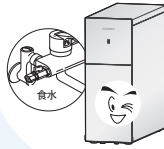

- 自來水(食水)以外的水源可引起疾病。
- 可能導致故障，縮短產品的壽命。

請勿損傷製冷劑電路。



- 可能導致產品損壞。

請勿任意於溫水裝置喉管連接減壓裝置。

- 可能導致產品損壞。

請勿讓兒童爬行或懸掛於產品上。

- 可能因產品掉下引致受傷。



請勿在以下場所安裝產品

- 室外
- 暴露在光線直接照射到的地方
- 洗手間附近
- 冷氣機或暖氣機前
- 傾斜的地方



請勿反覆啟動溫水出水及停止動作。

- 可能會產生蒸氣



使用蒸氣殺菌功能時請注意。

- 蒸氣殺菌運作時，請不要讓身體觸碰到蒸氣。(老人與孩童使用時需特別注意)
- 蒸氣殺菌功能運作時，請不要觸碰或移除殺菌杯。(取消運作蒸氣殺菌功能請參照第56頁)



使用當中

本產品為220-240V專用產品，請務必使用220-240V的專用插頭。

使用延長插座(多頭插座等)時請不要同時連接其他產品使用。

接地不良時可因漏電引起觸電事故。請務必接地後使用產品。

1 有接地端子的插座

如有接地端子，不需要另行作業可立即使用。

2 沒有接地端子的插座

確認是否有安裝漏電切斷器，如果沒有漏電切斷器，請安裝漏電切斷器後使用產品。

沒有漏電切斷器可能引起火災。



各部分的名稱

各部分的名稱

主體(正面, 背面)

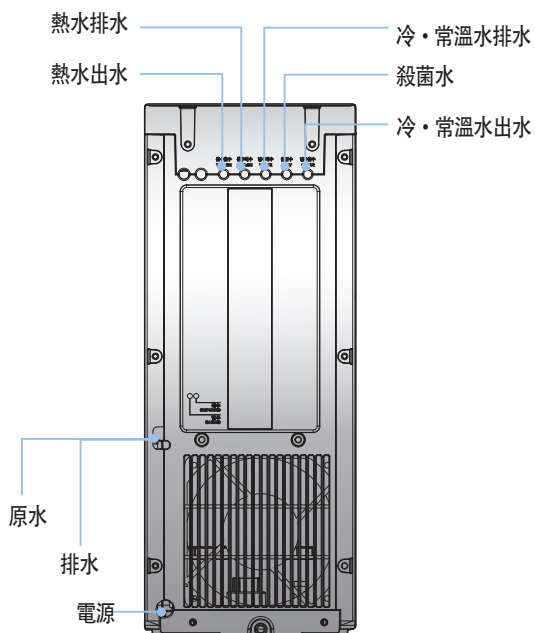
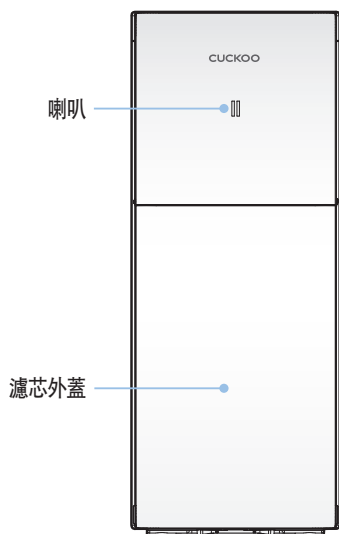

水龍頭(側面、上方) ※ LCD GUIDE並非可操作的部分。用力的話可能有破損的危險。

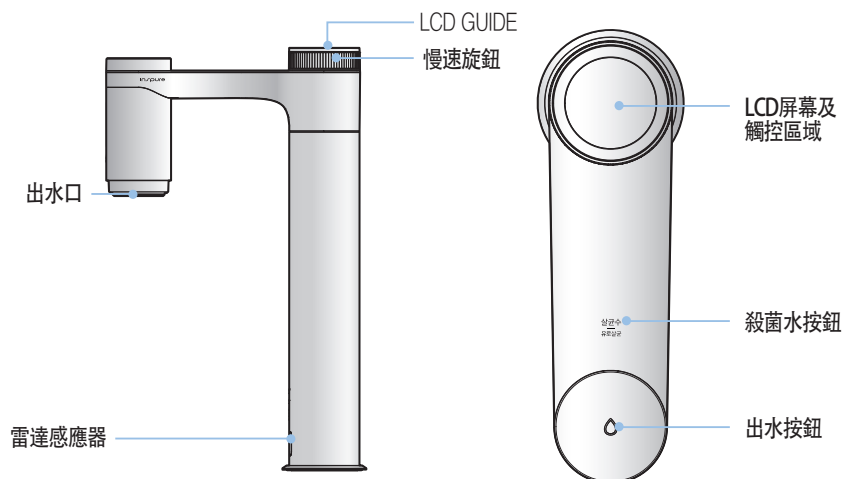



各部分的名稱

各部分的名稱

<顯示部分的詳細資訊>

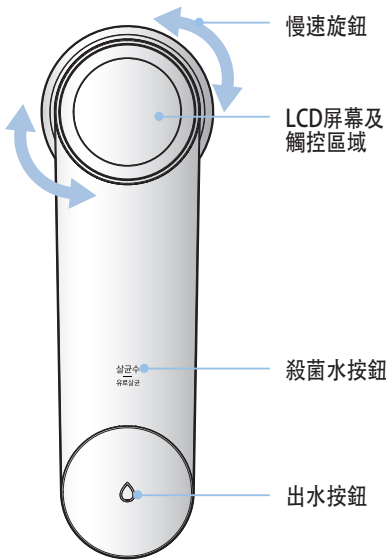

LCD觸控名稱

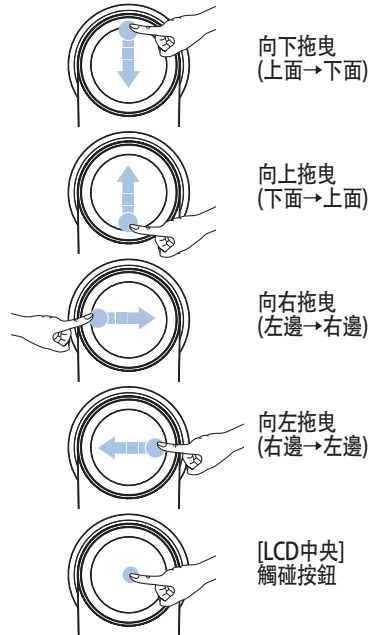

CHINESE

配件說明



使用說明書



保用卡



拉伸管帶及安裝材料



消毒杯
(如果丟失, 請聯繫客服中心購買新的)



濾水處理系統

濾水處理系統

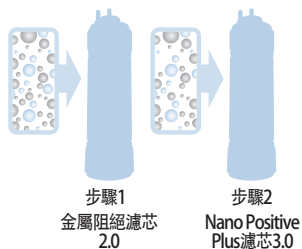

等級	濾芯名稱	濾芯功能
第1階段	金屬阻絕濾芯2.0	吸附去除7種重金屬（汞、鉛、鎘、砷、鐵、鋁、銅）及有機化學物質等
第2階段	Nano Positive Plus濾芯3.0	吸附去除微粒子、大腸桿菌、綠膿桿菌、金黃色葡萄球菌及諾羅病毒

※ 如使用非原廠濾芯或為原廠濾芯但已使用過長時間，可能造成濾芯性能不佳。



產品安裝辦法

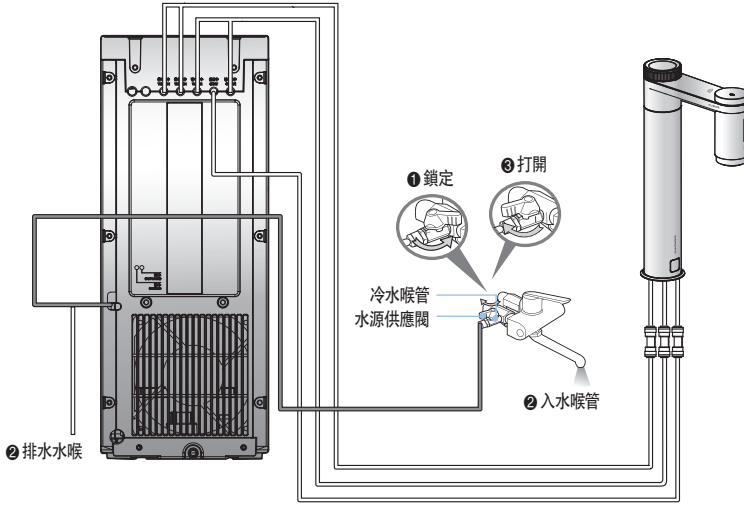

- ① 請安裝並鎖定水源供應閥。
 - 請務必使用上水道水源 請勿使用地下水等水源
- ② 請將水源供應喉連接到水源口(入水口)，將排水喉連接到排水口。
 - 請固定排水喉，確保排出的水不會濺到周邊。
 - 請勿將連接產品的排水喉安裝高於產品安裝面，或距離淨水器多於3m。
 - 如將排水喉觸及廚房等地面連接排水口，請勿提高於地面30cm以上。
- ③ 請將水源供應閥轉至“開”。
- ④ 請連結電源
- ⑤ 請使用自動濾芯洗滌功能清洗濾芯(自動濾芯洗滌請參考第60頁)。

完成安裝後請確認水管連接部分是否會漏水。

- 原水供給閥(水管部分)
- 原水(進水)水管、排水水管
- 水龍頭連接水管

※ 建議將產品安裝在水槽附近。

※ 為確保產品的最佳性能，請與本公司的安裝技師商議詳細的安裝方法。

※ 生產產品時，在檢驗過程中所用的水可能會部分殘留於產品內部，非使用過的產品，請安心使用。

※ 安裝產品時，請不要重覆使用已用過的原水供給閥與水管。

※ 產品初始安裝時(更換濾芯時)會進行10~15分鐘的自動濾芯清洗。



使用前確認事項

使用前確認事項

1 請開啟水源供應閥。

- ▶ 開啟水源供應閥後，請確認各個連接部位是否有漏水。
- 水源供應閥部及產品的水源(入水)、排水口product

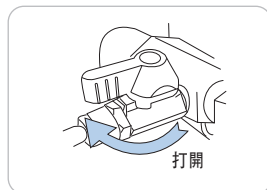

2 請將產品右側的過濾器門鎖桿轉向CLOSE方向。

- 濾水機供水。

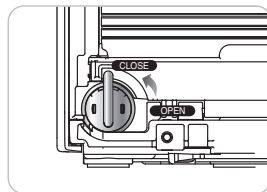

3 請連結電源

- ▶ 本產品是220-240V專用請務必連結專用插頭

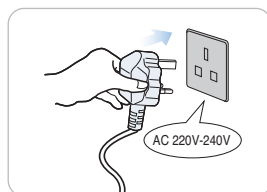

4 請定期性更換及管理濾芯

- ▶ 為了經常可飲用到乾淨水，需要定期更換及清潔濾芯。
- ▶ 濾芯更換的周期請參考第68頁。

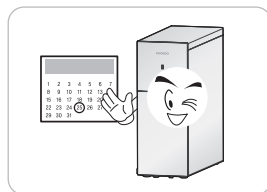



如果要設定功能

1 待機狀態

- ▶ 是可以出冷水、熱水、常溫水、殺菌水的待機模式。
LCD屏幕會根據選擇的功能來開啟並顯示出水量。
- ▶ 若使用者無任何操作，LCD屏幕會在15秒自動關閉。
- ▶ LCD屏幕在關閉的狀態下檢測到人體時會自動開啟。
(隱藏顯示器的使用方法請參考第57頁。)

2 使用者設定模式

- ▶ 在待機狀態下，往下(上面→下面)拖曳來進入使用者設定模式後，即可設定功能。

使用者設定模式	
進入使用者設定模式時	收藏流量設定
向左(右邊→左邊)拖曳1次	流量模式設定
向左(右邊→左邊)拖曳2次	語音音量設定
向左(右邊→左邊)拖曳3次	氛圍燈設定
向左(右邊→左邊)拖曳4次	自動濾芯清洗
向左(右邊→左邊)拖曳5次	屏幕旋轉設定
向左(右邊→左邊)拖曳6次	屏幕節能時間設定
向左(右邊→左邊)拖曳7次	流量起點調整設定
向左(右邊→左邊)拖曳8次	排水功能
向左(右邊→左邊)拖曳9次	殺菌預約週期設定
向左(右邊→左邊)拖曳10次	殺菌模塊更換提醒設定
向左(右邊→左邊)拖曳11次	濾芯更換提醒設定
向左(右邊→左邊)拖曳12次	LCD中央按鈕設定

3 定量出水

- ▶ 按一下[出水]或[LCD中央]按鈕後即可按照選擇定量出水。
- ▶ 可透過[慢速旋鈕]來選擇所需的量。
(半杯→一杯→兩杯→連續出水→收藏流量→重複循環)
- ▶ 可透過流量模式設定來選擇多種定量。
- ▶ 流量模式的使用方法請參考第58頁。



使用

設定冷水功能時

- 1 若冷水功能呈現OFF，請進入冷水鎖定設定模式以解除冷水鎖定功能。

- ▶ 在冷水功能畫面上(下面→上面)拖曳，以進入冷水鎖定設定模式。
- ▶ 進入冷水鎖定設定模式後透過左右拖曳來選擇冷水鎖定解除，並按下[LCD中央]按鈕來設定。



- 2 若不想使用冷水，請在進入冷水鎖定設定模式後，設定冷水鎖定功能。

- ▶ 在冷水功能畫面上(下面→上面)拖曳以進入冷水鎖定設定模式。
- ▶ 進入冷水鎖定設定模式後透過左右拖曳來選擇冷水鎖定，並按下[LCD中央]按鈕來設定。



- ※ 在開啟冷水功能約1個小時後即可穩定出冷水。
- ※ 產品初始功能設定為ON。

使用冷水時

- 1 在待機畫面中透過左右拖曳來選擇冷水功能畫面。

- ▶ 會發出“冷水”的語音提醒。

- 2 想定量出水時

- ▶ 透過轉動[慢速旋鈕]來選擇所需的出水量。
- ▶ 按下[出水]或[LCD中央]按鈕後，便會出冷水。
- ▶ 選擇的水量出完後，便會停止出水。
- ▶ 定量出水的過程中，若按下[出水]或其他按鈕，便會停止出水。

- 3 出冷水時，出水口指示燈會打開。

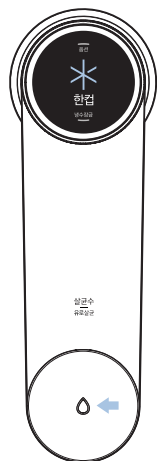



使用常溫水時

- 1 在待機畫面中透過左右拖曳來選擇常溫水功能畫面。
 - ▶ 會發出“常溫水”的語音提醒。
- 2 想定量出水時
 - ▶ 透過轉動[慢速旋鈕]來選擇所需的出水量。
 - ▶ 請按下[出水]或[LCD中央]按鈕。便會出常溫水。
 - ▶ 選擇的水量出完後，便會停止出水。
 - ▶ 定量出水的過程中，若按下[出水]或其他按鈕，便會停止出水。
- 3 出常溫水時，出水口指示燈會打開。

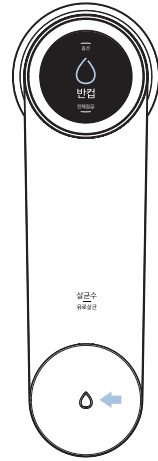

設定熱水鎖定功能時

這是為了防止兒童的任意操作和燒傷的保護功能。
設定完此功能後，[熱水]出水功能會停止運作

- 1 若不想使用熱水，請在進入熱水鎖定設定模式後，選擇熱水鎖定。
 - ▶ 在熱水功能畫面中向上(下面→上面)拖曳以進入熱水鎖定設定模式。
 - ▶ 進入熱水鎖定設定模式後透過左右拖曳來選擇熱水鎖定，並按下[LCD中央]按鈕來設定。





使用說明

使用熱水時(一般(通常)為100°C 熱水)

- 1 在待機畫面中透過左右拖曳來選擇熱水功能畫面。
 - ▶ 會發出“熱水”的語音提醒。
- 2 想定量出水時
 - ▶ 透過轉動[慢速旋鈕]來選擇所需的出水量。
 - ▶ 請按下[出水]或[LCD中央]按鈕。便會出熱水。
 - ▶ 選擇的水量出完後，便會停止出水。
 - ▶ 定量出水的過程中，若按下[出水]或其他按鈕，便會停止出水。
- 3 出熱水時，出水口指示燈會打開。
- 4 可能會根據周圍環境與使用條件而導致溫度差異。

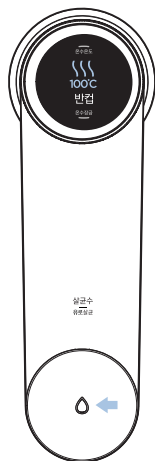

- ※ 澆水可能會導致燙傷的危險，請將杯子放在靠近出水口的地方。
- ※ 根據原水水壓，熱水出水時可能會發生水流晃動，請留意。
- ※ 注意事項
 - 長時間重覆使用熱水(高溫水)時，出水口可能會變燙，請留意。

使用熱水溫度功能(指定熱水)時

- 1 使用熱水溫度功能時
 - ▶ 在熱水功能畫面中往下(上面→下面)拖曳以進入熱水溫度設定模式。
 - ▶ 在溫水溫度設定畫面中，透過左右拖曳來選擇所需溫度後按下[LCD中央按鈕]。
100°C→40°C→50°C→60°C→70°C→80°C→重覆循環
 - ▶ 選擇熱水溫度後，請按下[出水]按鈕。
會依照選定的溫度出熱水。
 - ▶ 熱水出水時，若按下[出水]或其他任何按鈕，便會停止出水。



※ 熱水溫度等級





使用定量出水功能時

- 1 每轉動[慢速旋鈕]1次，即變動定量出水量。
 - ▶ 例如) EASY模式時，半杯 → 一杯 → 兩杯 → 連續出水 → 收藏流量 → 重覆循環
 - ▶ 收藏流量是使用者在設定所需流量後使用的流量功能，想變動收藏流量時，請參考第58頁。
- 2 選擇所需的定量出水量後按下[出水]按鈕，便會依照選定的量出水。
- 3 可在流量模式設定功能中設定所需的流量模式。流量模式的使用方法請參考第58頁。

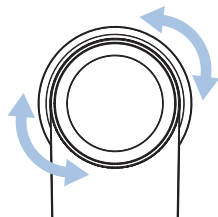

使用殺菌水時

- 1 請按下[殺菌水]按鈕來選擇殺菌水。
 - ▶ 按下[殺菌水]按鈕後便會顯示殺菌水功能畫面。
 - ▶ 會發出“殺菌水出水模式。”的語音提醒。
 - ▶ 轉動[慢速旋鈕]來選擇所需的殺菌水用量後，請按下[出水]按鈕。會依照所需的殺菌水用量出水。
- 2 殺菌水出水過程中想關閉時
 - ▶ 殺菌水出水時，若按下[出水]或其他任何按鈕，殺菌水便會停止出水。
 - ▶ 殺菌水出水結束後會進行水道清洗。會發出“水道清洗中，請稍後。”的語音提醒。
 - ▶ 水道清洗結束後會發出“水道已清洗完成。”的語音提醒。

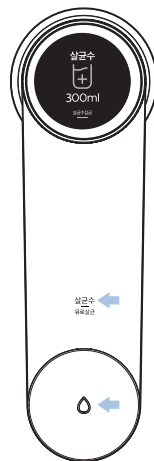

※ 水果與蔬菜的正確殺菌方法

- ▶ 殺菌前清除掉泥土等異物後，在殺菌水中浸泡約5分鐘以進行殺菌。
- ▶ 為確保清除殺菌水，請在殺菌後用清水沖洗3次以上。

※ 殺菌水不可飲用。請注意不要飲用到殺菌水。

(CUCKOO In & Out殺菌水嚴格控管在《飲用水管理法》的基準範圍內，請放心使用，但請勿飲用。)

※ 使用殺菌水時，為達到最大殺菌效果，請使用出水10秒後的殺菌水。(10秒內的殺菌水的殺菌效果可能還不完善。)



使用說明

使用立即自動殺菌功能時

這是在使用者所需的時間點開始自動殺菌的功能。

▶ 殺菌方式及所需時間和自動殺菌相同。

- 1 在待機狀態下，按住[殺菌水]按鈕約3秒。
 - ▶ 立即開始自動殺菌並發出“開始水道殺菌。”的語音提醒。
 - ▶ LCD屏幕上會出現殺菌圖像，並顯示殺菌進度。
-在LCD屏幕上顯示進度百分比。
- 2 若想取消殺菌，請在自動殺菌過程中按住[LCD中央]按鈕3秒。
 - ▶ 發出“水道殺菌中止。”的語音，並取消殺菌動作。
 - ▶ 根據情況的不同，進行殺菌水排水、沖洗、進水等後續流程，需要一定的時間來達到可取水的待機狀態。

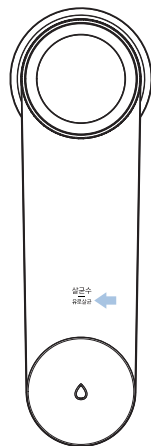

要使用立即電解殺菌與蒸汽殺菌時

- 1 請放殺菌杯。
 - ▶ 如右圖的參考線所示，轉動殺菌杯來使其與水龍頭的出水口高度一致。
 - ※ 殺菌杯的位置若比參考線高，則可能難以安裝。
- 2 檢測到殺菌杯時，可透過左右拖曳來選擇電解殺菌和蒸汽殺菌。
 - ▶ 選擇[電解殺菌]時
 - 開始電解殺菌並發出“開始電解殺菌。”的語音提醒。
 - ▶ 選擇[蒸汽殺菌]按鈕時
 - 開始蒸汽殺菌後發出“開始蒸汽殺菌。”的語音提醒。
 - ▶ LCD屏幕上會出現殺菌圖像，並顯示殺菌進度。
- 3 若想取消殺菌，請在電解殺菌時按住[LCD中央]按鈕3秒。
 - ▶ 發出“蒸汽或電解殺菌中止。”的語音後取消殺菌動作。
 - ▶ 取消電解殺菌時，為清洗電解殺菌部分，水會滲入電解殺菌部分，請勿取走殺菌杯。
 - ※ 運作結束後請取走殺菌杯。

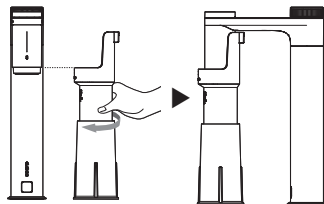

- ※ 殺菌水不可飲用。請注意不要飲用到殺菌水。
- ※ 蒸汽殺菌一天可使用一次。
- ※ 進行蒸汽殺菌時可能會變燙，請小心燙傷。
- ※ 蒸汽殺菌結束後產品正面可能會出現水滴。



使用說明

要使用隱藏顯示器功能時

這是降低顯示器OFF與顯示燈的亮度以節約能源的功能。

1 要進入隱藏顯示器模式時

- ▶ 在待機狀態下，未有按鈕動作與未檢測到人體超過15秒時
- ▶ 可在使用者設定模式中變更進入時間。
(請參閱第61頁的“LCD節電時間”)

2 要解除隱藏顯示器模式時

- ▶ 隱藏顯示器的狀態下檢測到人體時
- ▶ 隱藏顯示器的狀態下檢測到按鈕動作時
- ※ 進入隱藏顯示器後按下[出水]按鈕時可立即出水。
- ※ 使用者靠近產品正面時，人體檢測感應器會啟動。
(根據安裝環境的不同，感應器敏感度可能會有不同。)

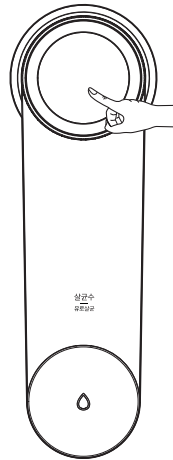

要使用全部鎖定功能時

這是防止兒童的任意操作與清潔產品時所使用的功能。
選定功能後，所有按鈕會被封鎖。

1 在常溫水功能畫面中向上(下面→上面)拖曳，以進入全部鎖定設定模式。

- ▶ 進入全部鎖定設定模式後，透過左右拖曳來選擇全部鎖定，再按下[LCD中央]按鈕後即完成全部鎖定。
- ▶ 在全部鎖定中選擇解除全部鎖定，再按下[LCD中央]後即解除全部鎖定。





使用說明

要變更收藏流量時

- 1 在常溫水功能或冷水功能畫面中往下(上面→下面)拖曳以進入選項設定模式。
- 2 要進入選項設定模式時
 - ▶ 會發出“收藏流量設定模式。”的語音提醒。
- 3 按下[LCD中央]按鈕以進入收藏流量設定模式。
- 4 透過左右拖曳或[慢速旋鈕]來設定收藏流量。
 - ▶ 每左右拖曳1次，即變動10ml。
 - 例如) 向左拖曳：350ml → 360ml → 370ml → . . . → 1500ml
 - 向右拖曳：350ml → 340ml → 330ml → . . . → 100ml
- 5 選擇所需的流量後請按下[LCD中央]按鈕來儲存。
 - ▶ 會發出“設定已完成。”的語音提醒。



要變更流量模式設定時

- 1 在常溫水功能或冷水功能畫面中往下(上面→下面)拖曳以進入選項設定模式。
- 2 在選項設定模式中向左(右邊→左邊)拖曳1次，以選擇流量模式的設定模式。
 - ▶ 會發出“流量模式的設定模式。”的語音提醒。
- 3 按下[LCD中央]按鈕來進入流量模式的設定模式。
- 4 透過左右拖曳或[慢速旋鈕]來設定流量模式功能。
 - ▶ 每左右拖曳1次，設定值就會變動。
 - 例如) EASY → SMART → CHEF → . . .
- 5 選擇所需的流量模式後請按下[LCD中央]按鈕來儲存。
 - ▶ 會發出“設定已完成。”的語音提醒。



※模式說明

- 1) EASY : 半杯(120ml), 一杯(250ml), 兩杯(500ml), 連續出水(1500ml)
- 2) SMART : 120ml → 200ml → 250ml → 350ml → 500ml → 550ml → 850ml → 1000ml → 1500ml
- 3) CHEF : 100ml → 150ml → 200ml → . . . → 1000ml → 1100ml → . . . → 1500ml
(100ml~1000ml區間增加50ml、1000ml~1500ml區間增加100ml)



要變更語音音量時

- 1 在常溫水功能或冷水功能畫面中往下(上面→下面)拖曳以進入選項設定模式。
- 2 在選項設定模式中向左(右邊→左邊)拖曳2次，以選擇語音音量設定模式。
 - ▶ 會發出“語音音量設定模式。”的語音提醒。
- 3 按下[LCD中央]按鈕來進入語音音量設定模式。
- 4 透過左右拖曳或[慢速旋鈕]來設定語音音量級別。
 - ▶ 每左右拖曳1次，便會根據當下設定的語音等級變動1個級別。
例如) 級別5 → 靜音模式 → 按鍵音 → 級別1 → 級別2 → 級別3 → 級別4 → 級別5
 - ▶ 想設定為最高音量時，請將設定值選為5。
 - ▶ 不使用語音提醒時，請選擇靜音模式或按鍵音。
- 5 選擇所需的語音音量後請按下[LCD中央]按鈕來儲存。
 - ▶ 會發出“設定已完成。”的語音提醒。



要使用氛圍燈功能時

- 1 常溫水功能或冷水功能畫面中往下(上面→下面)拖曳以進入選項設定模式。
- 2 在選項設定模式中向左(右邊→左邊)拖曳3次，以選擇氛圍燈設定模式。
 - ▶ 會發出“氛圍燈設定模式。”的語音提醒。
- 3 按下[LCD中央]按鈕來進入氛圍燈設定模式。
- 4 透過左右拖曳或[慢速旋鈕]來設定氛圍燈功能。
 - ▶ 每左右拖曳1次，設定值就會變動。
例如) ON → OFF → ON
- 5 選擇氛圍燈功能後請按下[LCD中央]按鈕來儲存。
 - ▶ 會發出“設定已完成。”的語音提醒。



※ 氛圍燈功能OFF時，[慢速旋鈕]部分的LED會關閉。



使用說明

要使用自動濾芯清洗功能時

- 1 在常溫水功能或冷水功能畫面中往下(上面→下面)拖曳以進入選項設定模式。
 - ▶ 在選項設定模式中向左(右邊→左邊)拖曳4次，以選擇自動濾芯清洗模式。
 - ▶ 會發出“自動濾芯清洗功能。”的語音提醒。
- 2 請按下[LCD中央]按鈕。
 - ▶ 發出“開始自動濾芯清洗。”的語音提醒後，會自動清洗濾芯。
 - ▶ 在LCD上會出現濾芯清洗圖像，並顯示濾芯清洗進度。
- 3 自動濾芯清洗結束時，會發出“自動濾芯清洗結束。”的語音提醒，並處於可出水的待機狀態。
- 4 要取消自動濾芯清洗功能時，請在自動濾芯清洗中按住[LCD中央]按鈕3秒。
 - ▶ 會發出“自動濾芯清洗中止。”的語音提醒。
- 5 自動濾芯清洗的所需時間會根據原水水壓而有所變化，需要約10~15分鐘。
 - ▶ 濾芯清洗過程中，如發出“需檢查原水進水狀況。”的語音提醒，則須打開產品正面的濾芯外蓋，並將鎖定桿轉向CLOSE。



要變更LCD屏幕旋轉時

- 1 在常溫水功能或冷水功能畫面中往下(上面→下面)拖曳以進入選項設定模式。
- 2 在選項設定模式中向左(右邊→左邊)拖曳5次，以選擇LCD屏幕旋轉設定模式。
 - ▶ 會發出“LCD屏幕旋轉設定模式。”的語音提醒。
- 3 按下[LCD中央]按鈕以進入LCD屏幕旋轉設定模式。
- 4 透過左右拖曳或[慢速旋鈕]來設定LCD屏幕角度。
例如) 0度 → 90度 → -90度
- 5 選擇屏幕角度後請按下[LCD中央]按鈕來儲存。
 - ▶ 會發出“設定已完成。”的語音提醒。





要變更LCD節電時間時

- 1 在常溫水功能或冷水功能畫面中往下(上面→下面)拖曳以進入選項設定模式。
- 2 在選項設定模式中向左(右邊→左邊)拖曳6次，以選擇螢幕節電時間設定模式。
 - ▶ 會發出“LCD節電進入時間設定模式。”的語音提醒。
- 3 按下[LCD中央]按鈕以進入畫面節電時間設定模式。
- 4 透過左右拖曳或[慢速旋鈕]來設定LCD節電時間。
 - ▶ 每左右拖曳1次，LCD節電時間就會變動。
 - 例如) 30秒 → 60秒 → 15秒 → 30秒
- 5 選擇LCD節電時間後請按下[LCD中央]按鈕來儲存。
 - ▶ 會發出“設定已完成。”的語音提醒。



要變更出水量時

- 1 在常溫水功能或冷水功能畫面中往下(上面→下面)拖曳以進入選項設定模式。
- 2 在選項設定模式中向左(右邊→左邊)拖曳7次，以選擇流量校正值設定模式。
 - ▶ 會發出“流量校正值設定模式。”的語音提醒。
- 3 按下[LCD中央]按鈕以進入流量校正值設定模式。
- 4 透過左右拖曳或[慢速旋鈕]來設定流量校正值。
 - ▶ 每左右拖曳1次，流量校正值就會變動。
 - 例如) 5% (出水量增加) → 10% → -10% → -5% (出水量減少) → 0%
- 5 選擇流量校正值後請按下[LCD中央]按鈕來儲存。
 - ▶ 會發出“設定已完成。”的語音提醒。



要排冷卻水時

- 1 在常溫水功能或冷水功能畫面中往下(上面→下面)拖曳以進入選項設定模式。
- 2 在選項設定模式中向左(右邊→左邊)拖曳8次，以選擇冷卻水排水模式。
 - ▶ 會發出“排水功能。”的語音提醒。
- 3 按下[LCD中央]按鈕後便會進入冷卻水排水功能。
- 4 進入冷卻水排水模式後，會自動進行冷卻水排水。





使用說明

自動殺菌預約週期設定

- 1 在常溫水功能或冷水功能畫面中往下(上面→下面)拖曳以進入選項設定模式。
- 2 在選項設定模式中向左(右邊→左邊)拖曳9次，以選擇殺菌週期設定模式。
▶ 會發出“殺菌週期設定模式。”的語音提醒。
- 3 按下[LCD中央]按鈕以進入殺菌週期設定模式。
- 4 透過左右拖曳或[慢速旋鈕]來設定殺菌週期。
▶ 每左右拖曳1次，殺菌週期就會變動。
例如) 5天 → 7天 → 10天 → OFF → 3天 → 5天
- 5 選擇殺菌週期後請按下[LCD中央]按鈕來儲存。
▶ 會發出“設定已完成。”的語音提醒。
※ 自動殺菌為OFF時，自動殺菌功能解除。



要設定殺菌模塊更換提醒功能時

- 1 在常溫水功能或冷水功能畫面中往下(上面→下面)拖曳以進入選項設定模式。
- 2 在選項設定模式中向左(右邊→左邊)拖曳10次，以選擇殺菌模塊更換提醒模式。
▶ 會發出“殺菌套件模塊更換提醒模式。”的語音提醒。
- 3 按下[LCD中央]按鈕以進入殺菌模塊更換提醒設定模式。
- 4 透過左右拖曳或[慢速旋鈕]來設定殺菌模塊更換提醒。
▶ 每左右拖曳1次，就會在ON/OFF中反覆變動。
例如) ON → OFF → ON → OFF → ...
- 5 選擇殺菌模塊使用量提醒ON/OFF後請按下[LCD中央]按鈕來儲存。
▶ 會發出“設定已完成。”的語音提醒。
※ 功能OFF時，不會有殺菌模塊使用量提醒。





要設定濾芯更換提醒功能時

- 1 在常溫水功能或冷水功能畫面中往下(上面→下面)拖曳以進入選項設定模式。
- 2 在選項設定模式中向左(右邊→左邊)拖曳11次，以選擇濾芯更換提醒設定模式。
▶ 會發出“濾芯更換提醒設定模式。”的語音提醒。
- 3 按下[LCD中央]按鈕以進入濾芯更換提醒設定模式。
- 4 透過左右拖曳或[慢速旋鈕]來設定濾芯更換提醒。
▶ 每左右拖曳1次，就會在ON/OFF中反覆變動。
例如) ON → OFF → ON → OFF → ...
- 5 選擇濾芯更換提醒ON/OFF後請按下[LCD中央]按鈕來儲存。
▶ 會發出“設定已完成。”的語音提醒。
※ 功能OFF時，不會有濾芯更換提醒。



要設定LCD中央按鈕出水功能時

- 1 在常溫水功能或冷水功能畫面中往下(上面→下面)拖曳以進入選項設定模式。
- 2 在選項設定模式中向左(右邊→左邊)拖曳12次，以選擇LCD中央按鈕設定模式。
▶ 會發出“LCD中央按鈕出水功能設定模式。”的語音提醒。
- 3 按下[LCD中央]按鈕以進入LCD中央按鈕設定模式。
- 4 透過左右拖曳或[慢速旋鈕]來設定LCD中央按鈕功能。
▶ 每左右拖曳1次，就會在ON/OFF中反覆變動。
例如) 出水ON → 出水OFF → ...
- 5 選擇LCD中央按鈕功能ON/OFF後請按下[LCD中央]按鈕來儲存。
▶ 會發出“設定已完成。”的語音提醒。
※ 功能OFF時，無法以LCD中央按鈕來出水





使用說明

要使用語言設置功能

- 1 在常溫水功能或冷水功能畫面中往下(上面→下面)拖曳以進入選項設定模式。
- 2 在選項設定模式中向左(右邊→左邊)拖曳13次，以選擇語言設定模式。
 - ▶ 會發出“這是語言設置模式”的語音提醒。
- 3 按下[LCD中央]按鈕來進入語言設定模式。
- 4 透過左右拖曳或[慢速旋鈕]來設定語言。
 - ▶ 每左右拖曳1次，設定語言會變動。
e.g. English -> Cantonese -> Mandarin
- 5 選擇語言後請按下[LCD中央]按鈕來儲存。
 - ▶ 會發出“設定已完成。”的語音提醒。





How to Clean

1 請使用柔軟的乾布擦拭。

- ▶ 擦拭前，請設定按鈕鎖定功能，以防止清潔時誤按。
- ▶ 如污染嚴重，請使用微濕的布擦拭。
(請勿使用苯、溶劑、研磨劑等產品清潔。)
- ▶ 在清潔產品時，請勿直接噴水清潔。
(會造成產品故障。)

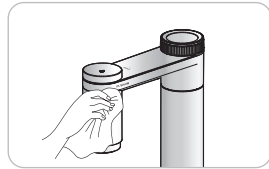
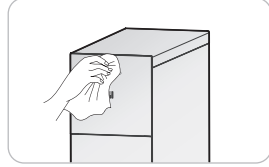

2 請將產品底部的濾網拉出分離， 用流水沖洗後晾乾後重新安裝。

- ▶ 如長時間不進行清潔，冷水功能可能會下降。

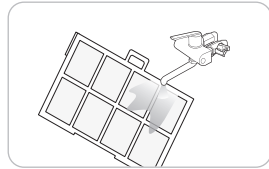



濾芯更換方法

濾芯更換方法(請務必使用Cuckoo 原裝正貨)

※ 濾芯門蓋感應器啟動中，更換濾芯時請不要切斷電源。

- 1 請將濾芯蓋分離。

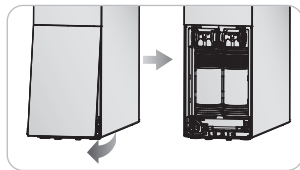

- 2 請如圖所示將產品正面的濾芯支架鎖定杆轉向 OPEN。

▶ 阻斷供水以防止於更換濾芯時流出。

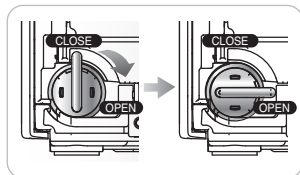

- 3 請如圖所示將濾芯支架往下壓。

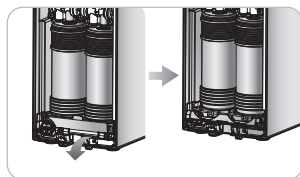

- 4 請於抬起濾芯後向外拉出以卸下。

▶ 於出現提示詞時去除排管內殘存壓力(殘壓)。
▶ 更換濾芯時可能根據使用者環境而有水滴滴出之情形，請於更換完成後擦乾。

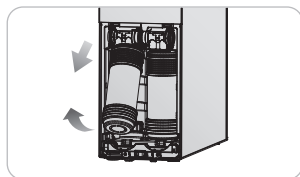



濾芯更換方法(請務必使用Cuckoo 原裝正貨)

- 5 請如圖所示於插入濾芯後向內推入濾芯盒以連接。
- ▶ 濾芯順序由左至右為金屬阻絕2.0及Nano Positive Plus 3.0。請注意順序。
 - ▶ 請確認濾芯是否正確安裝於濾芯盒。

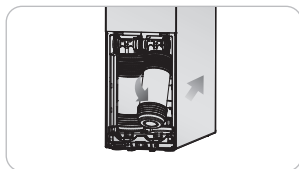

- 6 請如圖所示將濾芯支架向上拉。

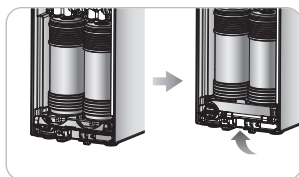

- 7 請如圖所示將產品正面的濾芯支架鎖定杆轉向CLOSE。

- ▶ 濾水機開始供水。

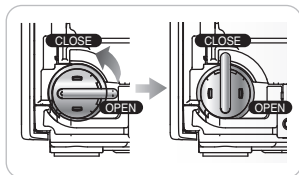

- 8 請如圖所示連接濾芯蓋。
(濾芯自動洗滌功能請參照第58頁。)

- ▶ 需準確對準上方凹槽才能順利安裝。

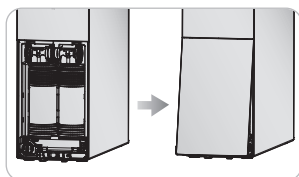

- 9 產品於待機狀態時，請使用濾芯自動洗滌功能清洗濾芯。
(濾芯自動洗滌功能請參照第58頁。)

- ※ 於濾芯清洗過程中出現“需進行輸入水源檢查”的語音提示時，請打開產品正面的濾芯蓋將鎖定杆轉向CLOSE。



濾芯更換週期/建議事項/濾芯排列圖

建議濾芯更換周期

- ▶ 濾芯更換週期以家庭內1日使用10L為基準而定，可能受水源狀況影響。

濾芯名稱	建議更換周期
金屬阻絕濾芯2.0	4個月
NANO POSITIVE PLUS 3.0濾芯	8個月

建議事項

- ▶ 濾芯更換周期
• 濾芯更換週期指經過精密分析預計出各個濾芯可發揮性能的時期。
這是以自來水為流入水，每天使用量約10L(飲用水(4人標準))時為基準，
使用量大時更換週期可能會更短。

濾芯排列圖

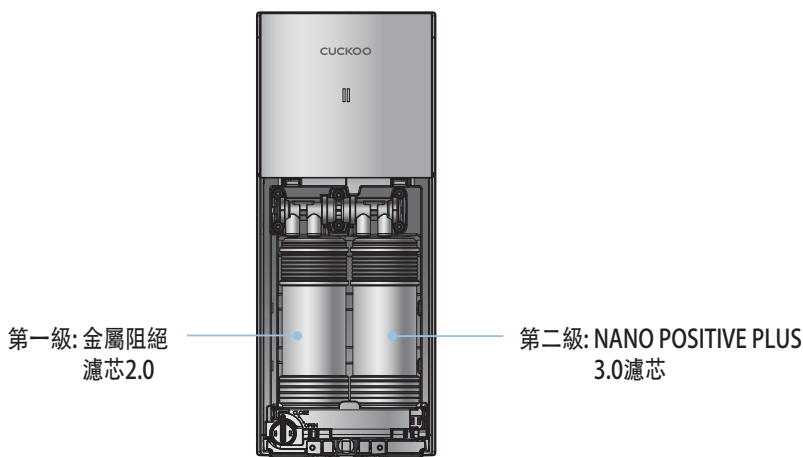

故障申報前先請確定

▼ 如沒有根據使用方法正確使用，即使不是故障，也有可能無法正常使用產品。
產品功能發生異常時，請參考以下檢查表作出檢查，如仍然有異常，請諮詢客服。

症狀	確認事項	調查事項
水中有令人不舒適的味道嗎？	<ul style="list-style-type: none"> • 有沒有很長時間沒有使用濾水器？ • 到了要更換濾芯的時間了嗎？ 	<ul style="list-style-type: none"> • 請進行自動濾芯洗滌(參考58頁) • 請向客服中心要求更換濾芯
水不出來	<ul style="list-style-type: none"> • 電源插頭插好了嗎？ • 水源供應正常嗎？ • 有正確按下[出水]按鈕嗎？ • 產品下面有積水嗎？ • 到了更換濾芯的時期了嗎？ • 濾芯門鎖桿開啟了嗎？ 	<ul style="list-style-type: none"> • 請插好電源插頭 • 請打開水源供應閥。 • 請確認供水喉沒有折到。 • 請確認有沒有被斷水。 • 請正確按下[出水]按鈕。 • 鎖起水源閥，拔掉電源後向客服諮詢。 • 請向客服商談室要求更換濾芯 • 請將產品左側的濾芯門鎖桿轉至CLOSE方向。(供水給濾水器)
冷水沒有出來	<ul style="list-style-type: none"> • 冷水大量出水嗎？ • 有沒有鎖起水源供應閥？ • 產品後方能通風嗎？ 	<ul style="list-style-type: none"> • 流出大量冷水後需要時間再次冷卻。 • 請確認水源供應閥。 • 請確認產品後方的隔熱板有沒有被擋住，並將障礙物清除。 • 請移動並安裝於通風良好的地方。(移動安裝產品時請聯絡客服。) • 通風口積塵時請聯絡客服。
熱水不夠熱。	<ul style="list-style-type: none"> • 是第一杯熱水嗎？ 	<ul style="list-style-type: none"> • 熱水第一次開啟時，第一杯的溫度可能會比較低。 • 請確認由第二杯開始是否以正常溫度流出熱水。

故障申報前先請確定

- ▼ 如沒有根據使用方法正確使用，即使不是故障，也有可能無法正常使用產品。
產品功能發生異常時，請參考以下檢查表作出檢查，如仍然有異常，請諮詢客服。

症狀	確認事項	調查事項
濾水量突然減少	<ul style="list-style-type: none"> • 是否鎖起水源供應閥？ • 是否過了更換濾芯的週期？ • 濾芯門鎖桿有否開啟？ 	<ul style="list-style-type: none"> • 請打開水源供給閥門 • 請更換Cuckoo正版濾芯。 • 請將產品右側的濾芯門鎖桿轉至CLOSE方向。 (供水給濾水器)
聲音很大	<ul style="list-style-type: none"> • 產品安裝的地面堅固平坦嗎？ • 碰到了其他物件了嗎？ • 有沒有正常組合接水盤？ • 產品的後方及兩旁有碰到牆壁嗎？ • 產品上方有放盆栽、書、座鐘等物件嗎？ 	<ul style="list-style-type: none"> • 請安裝於地面堅固及平坦的地方。 • 請不要與其他物件接觸。 • 如沒有正確安裝接水架，可能會產生異常噪音。 請確認接水架的安裝情況。 • 請將產品重新安裝於離牆壁有適當間隔 (20cm)以上地方。 • 請將產品上的物品清除。
水裡面有浮游物。	<ul style="list-style-type: none"> • 是否過了更換濾芯的週期？ 	<ul style="list-style-type: none"> • 請更換濾芯(Cuckoo正版濾芯)。
過濾後的水有微小的 粒子。	<ul style="list-style-type: none"> • 有沒有產生氣泡？ 	<ul style="list-style-type: none"> • 接上水源5分鐘後仍然有微細粒子的話， 立即聯絡服務中心。
濾水器漏水	<ul style="list-style-type: none"> • 組合(連結)部位有沒有損毀？ • 家中或外部環境潮濕嗎？ 	<ul style="list-style-type: none"> • 請把水管的水源供給閥門關閉並把濾水器電源插頭拔除後聯絡客戶服務中心。 • 濾水器內部冰冷的部分與濕氣接觸的話， 會產生凝結露水現象， 跟水杯產生水珠的原理一樣。

產品規格

產品名稱		電子冷水器(其他液體加熱器)	
品項名稱		CUCKOO冷熱淨水器	
款式名稱		淨水器	
款式名稱		CP-AAN100ULW (LUMI WHITE)	
額定電壓		單向 220-240V~/50 Hz	
消耗電力		冷水 0.6A, 溫水 2400W	
過濾方式		靜電吸附過濾方式	
濾芯類型		金屬阻絕濾芯2.0	Nano Positive Plus濾芯3.0
濾芯介紹		聚丙烯、壓縮活性炭	聚丙烯、纖維素、活性炭、壓縮活性炭、聚矽
濾芯更換週期		4個月	8個月
容量	濾水	直輸式	
	冷水	直輸式	
氣候等級		T	
產品	主體	重量	約11 kg
		尺寸 (W×D×H)	166mm×390mm×418mm
	水龍頭	重量	約0.9 kg
		尺寸 (W×D×H)	61mm × 187mm × 306mm
使用原水壓力		0.07 ~ 0.69 MPa (0.7 ~ 6.9bar)	
使用環境溫度		5 ~ 40°C	
使用原水溫度		5 ~ 35°C	

※ 本說明書中標註的內容(外觀、設計與規格)可能基於考量提高產品品質而在未事先告知的情形下變更。

※ 製造來源: Cuckoo Homesys Co. Ltd

CUCKOO

<http://www.owell.hk>

We provide satisfying consultation and services concerning your complaints, suggestions, and recommendations upon receiving your troubled product model name, status, and contact information.

- ♣ After reading this manual, keep it in a place easily accessible to the user for future reference.
- ♣ This manual includes the warranty.
- ♣ Caution : Please read this manual carefully to ensure safety and a longer product lifespan.

OWELL INTERNATIONAL LIMITED
Unit 703, 7/F, Join-In Hang Sing Centre, 2-16 Kwai Fung Crescent, Kwai Chung, Hong Kong
Careline: 852-2317 7776

10383-0034B0 Rev.0